



SLAYTON 42

Model: #SLA-42

DIRECT VENT LINEAR FIREPLACE

IMPORTANT: This installation manual is to be used in conjunction with SUPPLEMENTAL INSTALLATION AND HOMEOWNER INFORMATION MANUAL. Read both manuals before installing and operating appliance.

INSTALLER: Leave this manual with the appliance.
CONSUMER: Retain this manual for future reference.

English and French Installation Manuals
Available Through Your Local Dealer or
Visit Our Website at www.kozyheat.com

This appliance may be installed in an aftermarket permanently located, manufactured home (USA only) or mobile home, where not prohibited by local codes.

This appliance is only for use with the type of gas indicated on the rating plate. This appliance is not convertible for use with other gases, unless a certified kit is used.

WARNING: If the information in these instructions is not followed exactly, a fire or explosion may result causing property damage, personal injury or loss of life.

—Do not store or use gasoline or other flammable vapors and liquids in the vicinity of this or any other appliance.

WHAT TO DO IF YOU SMELL GAS:

- Do not try to light any appliance.
- Do not touch any electrical switch: do not use any phone in your building.
- Immediately call gas supplier from a neighbors phone. Follow the gas supplier instructions
- If you cannot reach your gas supplier, call the fire department.

— Installation and service must be performed by a qualified installer, service agency or the gas supplier.



WARNING



**HOT GLASS WILL CAUSE BURNS.
DO NOT TOUCH GLASS UNTIL COOLED.
NEVER ALLOW CHILDREN TO TOUCH GLASS.**



Report No. 216-S-36c-6.5

MARCH 2013
SLA-42-REV-04-SEPERATE

INTRODUCTION

Read this manual before installing or operating this appliance.
Please retain this owner's manual for future reference.

CONGRATULATIONS!

We welcome you as a new owner of a Kozy Heat gas fireplace. Kozy Heat products are designed with superior components and materials and assembled by trained craftsmen who take pride in their work. The burner and valve assembly are 100% test-fired and the complete fireplace is thoroughly inspected before packaging to ensure that you receive a quality product. Our commitment to quality and customer satisfaction have remained the same for over 30 years. We offer a complete line of gas and wood fireplaces, unique cabinets and stylish accessories to compliment any décor. Adding a fireplace is one of the best ways to increase the value of your home and we are proud to offer a network of dealers throughout the country to help make your experience everything you imagine. We pride ourselves in being dedicated to not only function and reliability, but customer safety as well. We offer our continual support and guidance to help you achieve the maximum benefit and enjoyment from your Kozy Heat gas fireplace.

Jim Hussong
President



Dudley Hussong
Board Chairman



Homeowner Reference Information

We recommend that you record the following information about your fireplace.

Model Name: _____ Date purchased/installed: _____

Serial Number: _____ Location on fireplace: _____

Dealership purchased from: _____ Dealer Phone: _____

Notes: _____

TABLE OF CONTENTS

<u>INTRODUCTION</u>	
Introduction and Homeowner Reference Information	1
<u>CONTENTS</u>	
Table of Contents	2
<u>SAFETY INFORMATION</u>	
Safety Information	3
<u>COMMONWEALTH OF MASSACHUSETTS INFORMATION</u>	
Commonwealth of Massachusetts Information	4
<u>SPECIFICATIONS</u>	
Fireplace Dimensions	5
Clearances	5
Additional Components Required	6
Installation Overview	6
Placement Clearance Requirements	6
Television Positioning Considerations	6
<u>FIREPLACE PREPARATION</u>	
Stand-off / Stand-off Heat Shield Assembly & Installation	7
Nailing Flange Assembly & Installation	8
<u>FRAMING</u>	
Wall Enclosure Rough Opening	9
Minimum Finished Opening Dimensions	9-10
Vertical Terminations	10
Horizontal Terminations	10
Facing and Finishing	11
<u>TYPICAL INSTALLATION OPTIONS</u>	
Typical Installation Options	12
<u>MANTEL REQUIREMENTS</u>	
Mantel Requirements	13
<u>GLASS FRAME / CONTEMPORARY FRAME</u>	
Glass Frame Assembly Removal / Installation	13
<u>GAS LINE CONNECTION</u>	
Gas Line Connection	14
<u>VENTING</u>	
Approved Venting	15
Horizontal Vent System Clearances	15
Horizontal Termination Minimum / Maximum	15
#800-WPT Wall Pass-Thru Installation Instructions	16
Horizontal Min. / Max. Venting Illustrations	17
Horizontal Vent Heat Shield Installation Instructions	17
Vertical Vent System Clearances	18
Vertical Min. / Max. Venting Illustrations	18
Restrictor	18

<u>VENTING (cont.)</u>	
Elbows	19
Horizontal & Vertical Combination Venting Illustrations	19
#800 Series Flex Vent Installation Instructions	20-21
Termination Vent Cap Location	22
Vent Termination Clearances	23
<u>LIGHT KIT</u>	
Light Kit	24
<u>GLASS MEDIA INSTALLATION</u>	
Glass Media Installation	24
<u>CONTROL BOARD</u>	
Control Board Removal	25
Control Board Installation	25
<u>FINALIZING THE INSTALLATION</u>	
Burner Tube Adjustment / Troubleshooting	26
Restrictor Troubleshooting / Installation after Termination Completion	27
<u>MAINTENANCE</u>	
Maintenance	28
<u>OPTIONAL #970 HEAT DUCT KIT INSTALLATION</u>	
Optional #970 Heat Duct Kit Installation	29-32
<u>WARRANTY</u>	
Warranty	33-34

SAFETY INFORMATION

This fireplace has been tested by OMNI-Test Laboratories, Portland, Oregon and complies with:

ANSI Z21.88-2009/CSA 2.33-2009, "Standard for Vented Gas Fireplace Heaters."
CAN 2.14-M91 (R2009), "Gas-Fired for Use at High Altitudes."
CAN/CSA P.4.1-09, "Testing Method for Measuring Annual Efficiency".

This installation must conform with local codes, or in the absence of local codes, with the *National Fuel Gas Code, ANSI Z223.1/NFPA 54*, or the *Natural Gas and Propane Installation Code, CSA B149.1*

- Installation and repair should be done only by a qualified service person. The appliance should be inspected by a qualified service person before use. Annual inspection by a qualified service person is required to maintain warranty. More frequent cleaning may be required due to excessive lint from carpeting, bedding materials, etc. It is imperative that control compartments, burners and circulation air passageways of the appliance be kept clean.
- If this appliance is installed directly on carpeting, tile or other combustible material other than wood flooring, the appliance shall be installed on a metal or wood panel extending the full width and depth of the appliance.
- Children and adults should be alerted to the hazards of high surface temperatures and should stay away to avoid burns or clothing ignition.
- Young children should be carefully supervised when they are in the same room as the appliance. Toddlers, young children and others may be susceptible to accidental contact burns. A physical barrier is recommended if there are at risk individuals in the house. To restrict access to a fireplace or stove, install an adjustable safety gate to keep toddlers, young children and other at risk individuals out of the room and away from hot surfaces.
- Clothing or other flammable material should not be placed on or near the appliance.
- Adequate accessibility clearances for servicing and proper operation must be maintained.
- This appliance must not share or be connected to a chimney flue serving any other appliance.
- Keep area around the appliance clear of combustible materials, gasoline and other flammable vapor and liquids.
- The flow of combustion and ventilation air must not be obstructed.
- Due to high temperatures the appliance should be located out of traffic and away from furniture and draperies.
- The glass front or any part removed for servicing the appliance must be replaced prior to operating the appliance. Work should be done by a qualified service technician.
- Clean glass only when cool and only with non-abrasive cleansers.
- **WARNING: DO NOT OPERATE APPLIANCE WITH THE GLASS/FRAME ASSEMBLY REMOVED, CRACKED OR BROKEN. REPLACEMENT OF THE GLASS SHOULD ONLY BE PERFORMED BY A LICENSED OR QUALIFIED SERVICE PERSON.**
- The glass assembly, Part #SL42-057T, shall only be replaced as a complete unit, as supplied by Hussong Mfg. Co., Inc. DO NOT SUBSTITUTE MATERIALS.
- Do not strike or slam glass assembly.
- Any safety screen or guard removed for servicing the appliance must be replaced prior to operating the appliance.
- Under no circumstances should any solid fuel (wood, coal, paper or cardboard etc.) be used in this appliance.
- Keep burner and control compartment clean.
- Do not use this fireplace if any part has been under water. Immediately call a qualified service technician to inspect this appliance and to replace any part of the control system and any gas control which has been under water.

COMMONWEALTH OF MASSACHUSETTS REQUIREMENTS

NOTE

The following requirements reference various Massachusetts and national codes not contained in this manual.

For all sidewall horizontally vented gas fueled equipment installed in every dwelling, building or structure used in whole or in part for residential purposes, including those owned or operated by the Commonwealth and where the side wall exhaust vent termination is less than (7) feet above finished grade in the area of the venting, including but not limited to decks and porches, the following requirements shall be satisfied:

INSTALLATION OF CARBON MONOXIDE DETECTORS

At time of installation of side wall horizontally vented gas fueled equipment, the installing plumber or gas-fitter shall observe that a hard wired carbon monoxide detector with an alarm and battery back-up is installed on the floor level where the gas equipment is to be installed. In addition, the installing plumber or gas-fitter shall observe that a battery operated or hard wired carbon monoxide detector is installed on each additional level of the dwelling, building or structure served by the side wall horizontal vented gas fueled equipment. It shall be the responsibility of the property owner to secure the services of qualified licensed professionals for the installation of hard wired carbon monoxide detectors.

In the event that the side wall horizontally vented gas fueled equipment is installed in a crawl space or attic, the hard wired carbon monoxide detector with alarm and battery back-up may be installed on the next adjacent floor level.

In the event that the requirements of this subdivision can not be met at the time of completion of installation, the owner shall have a period of thirty (30) days to comply with the above requirements; provided, however, that during said thirty (30) day period, a battery operated carbon monoxide detector with an alarm shall be installed.

APPROVED CARBON MONOXIDE DETECTORS

Each carbon monoxide detector as required in accordance with the above provisions shall comply with NFPA 720 and be ANSI/UL 2034 listed and IAS certified.

SIGNAGE

A metal or plastic identification plate shall be permanently mounted to the exterior of the building at a minimum of eight (8) feet above grade directly in line with the exhaust vent terminal for the horizontally vented gas fueled heating appliance or equipment. The sign shall read, in print no less the one-half inch (1/2) in size, "GAS VENT DIRECTLY BELOW. KEEP CLEAR OF ALL OBSTRUCTIONS".

INSPECTION

The state or local gas inspector of the side wall horizontally vented gas fueled equipment shall not approve the installation unless, upon inspection, the inspector observes carbon monoxide detectors and signage installed in accordance with the provisions of 248 CMR 5.08 (2) (a) 1 through 4.

EXEMPTIONS

The following equipment is exempt from 248 CMR 5.08 (2) (a) 1 through 4: The equipment listed in Chapter 10 entitled "Equipment Not Required To Be Vented" in the most current edition of NFPA 54 as adopted by the Board; and Product Approved side wall horizontally vented gas fueled equipment installed in a room or structure separate from the dwelling, building or structure used in whole or in part for residential purposes.

MANUFACTURER REQUIREMENTS - GAS EQUIPMENT VENTING SYSTEM PROVIDED

When the manufacturer of Product Approved side wall horizontally vented gas equipment provides a venting system design or venting system components with the equipment, the instructions provided by the manufacturer for installation of the equipment and the venting system shall include:

Detailed instructions for the installation of the venting system design or the venting system components; and

A complete parts list for the venting system design or venting system.

MANUFACTURER REQUIREMENTS - GAS EQUIPMENT VENTING SYSTEM NOT PROVIDED

When the manufacturer of Product Approved side wall horizontally vented gas equipment does not provide the parts for venting the flue gases, but identifies "special venting systems", the following requirements shall be satisfied by the manufacturer:

The referenced "special venting systems" instructions shall be included with the appliance or equipment installation instructions and;

The "special venting systems" shall be Product Approved by the Board, and the instructions for that system shall include a parts list and detailed installation instructions.

A copy of all installation instructions for all Product Approved side wall horizontally vented gas fueled equipment, all venting instructions, all parts lists for venting instructions, and/or all venting design instructions shall remain with the appliance or equipment at the completion of the installation.

SPECIFICATIONS

FIREPLACE DIMENSIONS

FIREPLACE DIMENSIONS	DESCRIPTION	Height	Width	Back Width	Depth	Opening Width	Glass Frame Height	Top Stand-off Height	Back to vent center
	INCHES	30-9/16	50	50	16-3/8	45-7/16	18-3/4	7-3/4	7-5/16
	MILLIMETERS	776	1271	1271	415	1154	477	197	186

WARNING

All stand-off brackets must be attached to fireplace. Do not remove. Top stand-off brackets are not load bearing. Non-combustible zone: Top stand-offs provide 7-3/4" (197mm) minimum clearance to header. Use only non-combustible material in this area for entire width of fireplace. **Do not** use wood, sheetrock etc. in this zone. Other clearances apply. All clearances must be maintained.

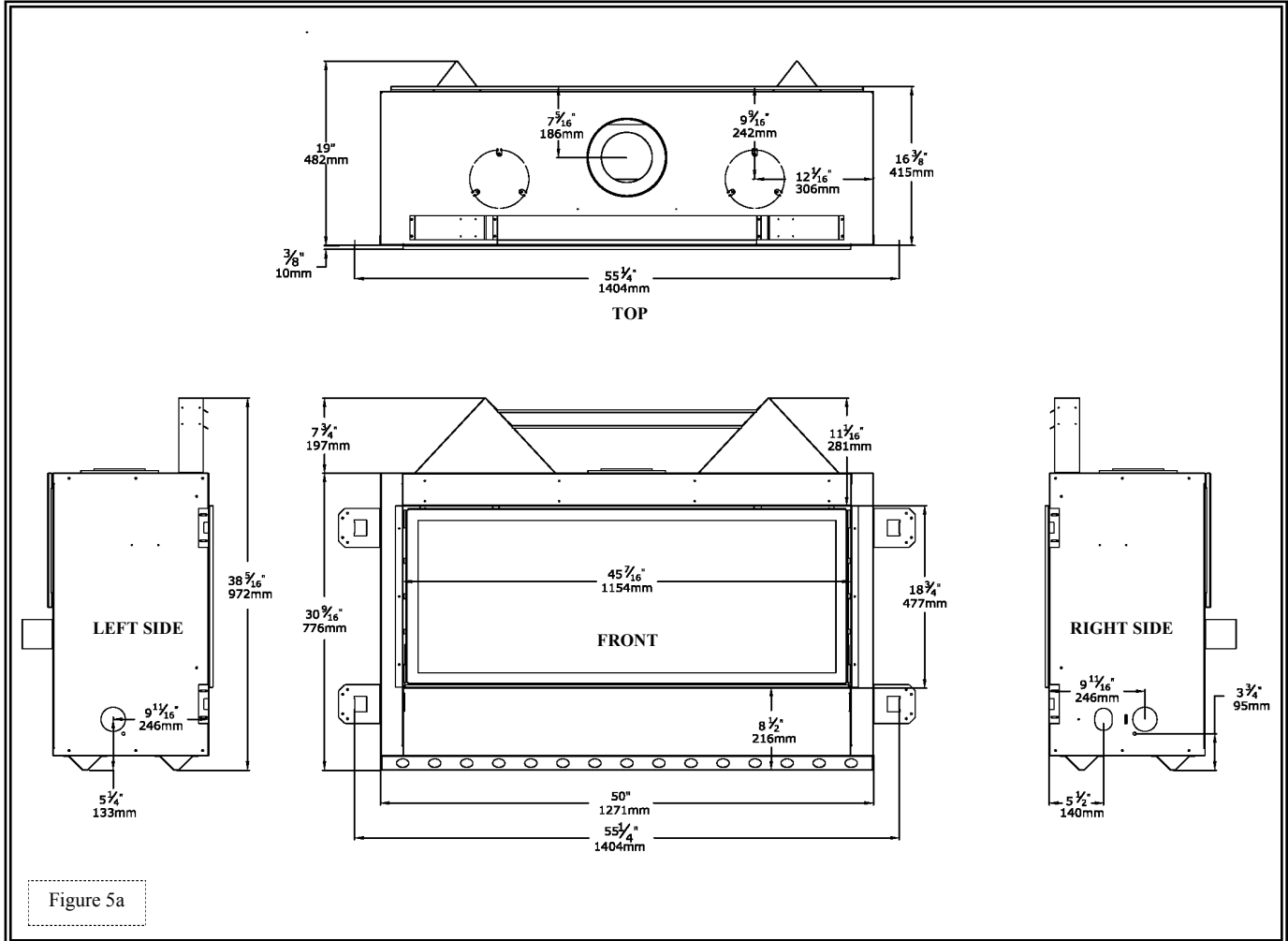

Figure 5a

CLEARANCES

Top of unit face to framing	7-3/4" (197mm)
From unit left & right side stand-offs	0"
From unit back stand-offs	0"
From bottom stand-offs	0"
Unit top to ceiling	31" (787mm)
Side of finishing edge to adjacent sidewall	6" (152mm)
Unit front to combustibles	36" (914mm)
Mantel 9" (129mm) deep from fireplace finishing edge	10-3/4" (273mm)

SPECIFICATIONS

ADDITIONAL COMPONENTS REQUIRED

- Vent System: Approved venting listed on page 15 of this installation manual.
- Glass Media: Various colors available. See Dealer for details.

INSTALLATION OVERVIEW

NOTE

The qualified installer should follow the procedure best suited for the installation.

1. Frame an opening for fireplace, allowing for vent installation and type of installation (corner or flat wall application).
2. If masonry (optional) is used, prepare foundation for the masonry load. A lintel is required to support the added weight above fireplace.
3. Attach stand-off brackets and nailing flanges to fireplace.
4. Insert fireplace into framing.
5. Install hearth (if applicable).
6. Complete gas line installation.
7. Complete electrical hook-up. Install any standard or optional electrical components at this time.
8. Complete venting installation.
9. Secure fireplace to framing with nailing flanges. Verify all clearances at this point.
10. Install facing material, mantel or cabinetry, allowing room for optional full face doors, if applicable.
11. Install glass media (required).
12. Install finishing material, optional surrounds.
13. Verify proper operation of fireplace and all components.

PLACEMENT CLEARANCE REQUIREMENTS

- This fireplace must be installed on a level surface capable of supporting fireplace and venting.
- Fireplace must be placed directly on wood or non-combustible surface (not linoleum or carpet) extending entire depth and width of fireplace.
- Due to high surface temperatures, fireplace should be located out of traffic and away from furniture and draperies.
- This fireplace may be installed in a bedroom.
- Please be aware of the large amount of heat this fireplace will produce when determining a location.

TELEVISION POSITIONING CONSIDERATIONS

Mounting a TV above a fireplace has become common practice. With this in mind, we advise you to read the following paragraphs carefully before considering installing a television above your fireplace.

Most TV manufacturers specify in their instructions that a TV should not be installed on, near, or above a heat source. Television location rests solely on the homeowner and Hussong Manufacturing will not be held liable for any adverse affects on a TV located near a Kozy Heat Fireplace that may be caused by heat.

TV operating temperature is also affected by wall and mantle construction material. It is the customers responsibility to satisfy themselves that their TV mounting and mantle design will not exceed the listed maximum operating temperature of their electronic goods.

FIREPLACE PREPARATION

STAND-OFF / STAND-OFF HEAT SHIELD ASSEMBLY & INSTALLATION

WARNING

Top and back stand-off brackets must be formed and attached prior to positioning fireplace into framed opening.

Top stand-offs provide 7-3/4" (197mm) minimum clearance to header. Use only non-combustible material in this area for entire width of fireplace. Do not use wood, sheetrock, etc. in this zone. Other clearances apply. All clearances must be maintained.

Top stand-off brackets are not load bearing.

Top stand-off brackets and stand-off heat shields are attached to fireplace top, back stand-offs are attached to back of fireplace in a flat state for shipping.

1. Remove and save (4) screws securing top stand-off heat shield and stand-off brackets. Form each stand-off bracket as shown.
2. Re-attach top stand-off brackets to fireplace using screws previously removed along with (4) screws provided in fireplace components packet.
3. Form stand-off heat shields and attach to stand-off brackets with (8) screws provided in fireplace components packet. (Flange on stand-off heat shields face down and to front of fireplace).
4. Form back stand-offs and secure to fireplace back with provided screws.

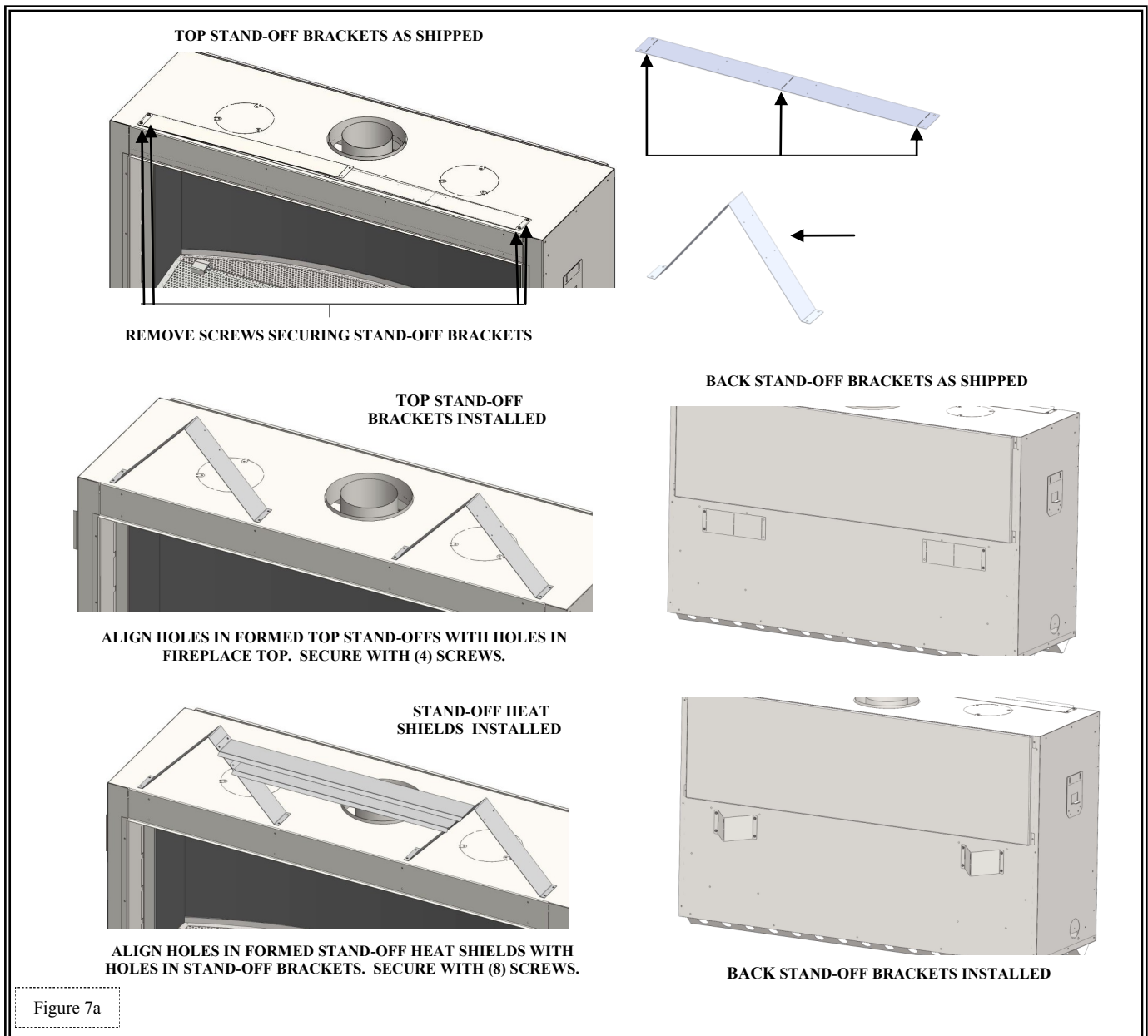

FIREPLACE PREPARATION

NAILING FLANGE ASSEMBLY & INSTALLATION

1. Remove (4) nailing flanges from fireplace sides.
2. With the 1/2" (13mm) long stand-offs on nailing flanges facing away from fireplace, align nailing flange with holes on outside corners of fireplace. Secure with screws (provided in components packet) through slots in nailing flanges.
3. Bend perforation on nailing flange until parallel with fireplace face. Do not bend toward fireplace face.
4. Position framing stud against 1/2" (13mm) long stand-off (located on backside of nailing flange). Secure with nails or screws.

NOTE

Depending on facing material, tabs can be adjusted forward or back wards up to 1/2" (13mm).

CAUTION

Never permanently remove these assemblies from fireplace - they must be secured in place regardless of finish material used.

When installed, nailing flanges provide the minimum 2-1/2" (64mm) clearance from fireplace sides.

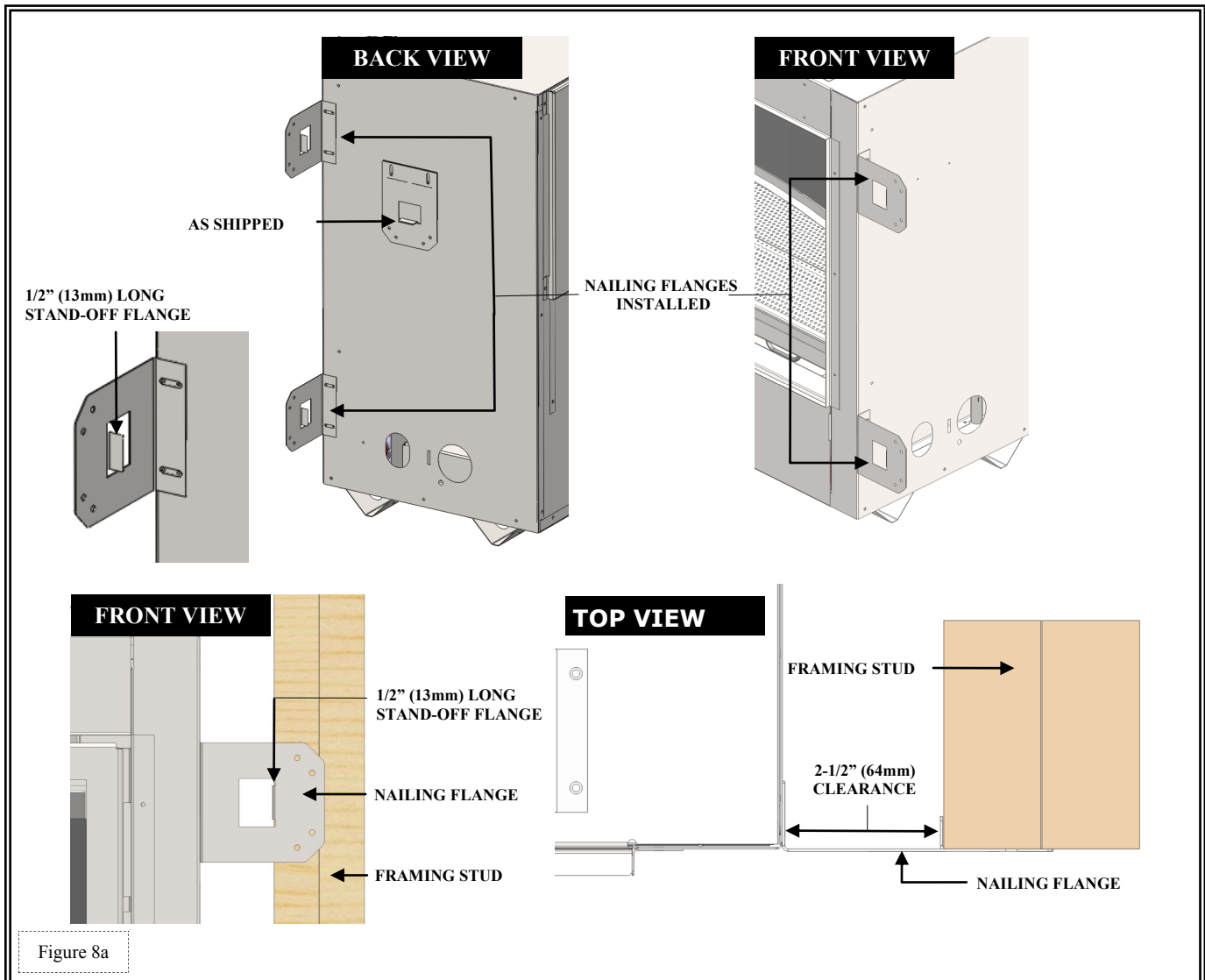

FRAMING

WALL ENCLOSURE ROUGH OPENING

IMPORTANT

Determine whether wall surface will be flush with fireplace face (wall and fireplace face will be covered with non-combustible material such as tile) *or*, framing will be flush with fireplace face, which results in a flat wall appearance.

Header and top framing studs must be rotated. Please refer to illustration below for guidance.

Framing dimensions should allow for wall covering thickness and fireplace facing materials. If using a hearth, adjust rough opening size as necessary to maintain clearance requirements.

This fireplace may be elevated off floor as shown in illustration below, provided it is properly supported by framing materials and ceiling clearances are maintained.

If installing optional #970 Heat Duct Kit, refer to installation instructions on pages 29-32 of this installation manual.

MINIMUM FINISHED OPENING DIMENSIONS

(APPLIES TO BOTH HORIZONTAL AND VERTICAL VENTING TERMINATIONS)

38-3/8" (975mm) High x 55-1/4" (1403mm) Wide x 19" (483mm) Deep.*

WARNING

PROVIDE ADEQUATE CLEARANCES AROUND AIR OPENINGS INTO THE COMBUSTION CHAMBER.

DO NOT OBSTRUCT UPPER AND LOWER GRILL OPENINGS. ROOM AIR ENTERS THROUGH LOWER PASSAGE, IS HEATED AND EXITS THROUGH UPPER PASSAGE. BLOCKING THESE PASSAGES MAY RESULT IN OVERHEATING, CREATING A POTENTIALLY HAZARDOUS SITUATION.

*19" represents minimum distance from front of fireplace to back wall of framing. This is the minimum wall depth required for wall surface material to cover fireplace front.

If you desire wall surface to be flush with fireplace face, subtract 1/2" (standard drywall depth) from this dimension.

If using another material, adjust accordingly.

Maintain all clearances to combustibles as outlined in this manual.

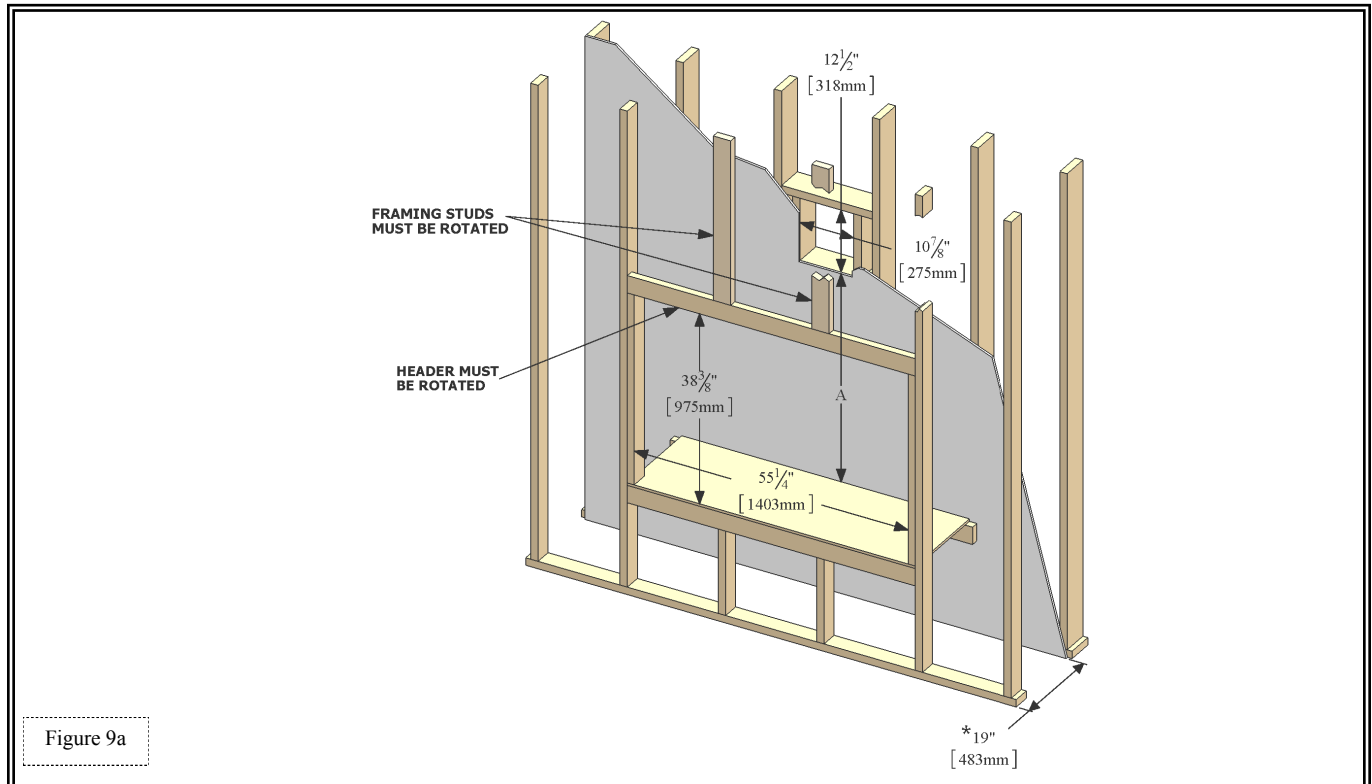

FRAMING

Determine exact position of your fireplace, including hearth height, width, and depth, (if applicable). If possible, place fireplace in such a manner that vent termination will be placed between two studs, eliminating the need for additional framing.

If masonry is to be used (optional), prepare necessary foundation for the masonry load. When masonry construction is being used, a lintel must be used over top of fireplace to support the added weight.

Build hearth to desired size and height. If a hearth extension is desired, combustible material may be used.

NOTE Consider height of hearth finish material (stone, brick, etc.) when building fireplace platform. The bottom of fireplace must be level with finished hearth to allow for proper fit of contemporary frames.

WARNING Install fireplace on hard metal or wood surface extending the full width and depth of fireplace. Minimum platform size: 50" (1271mm) wide x 19" (482mm) deep. ABOVE FLOOR LEVEL INSTALLATIONS: Solid continuous platform must be constructed below appliance.

FIRE HAZARD Do NOT install directly on carpeting, vinyl, or any combustible material other than wood.

IMPORTANT Vent cap location must be in compliance with guidelines on page #22 of this manual.

WARNING DO NOT RECESS VENT CAP INTO WALL OR SIDING.

VERTICAL TERMINATIONS

Follow vent pipe manufacturer's installation instructions for vertical terminations. A minimum 1" (25mm) clearance on all sides of vertical vent pipe must be maintained.

NOTE The included Horizontal Vent Heat Shield is not used for vertical configurations.

HORIZONTAL TERMINATIONS

Frame a 12-1/2" (318mm) high (H) x 10-7/8" (276mm) wide (W) opening on exterior wall for chimney termination. This opening size includes required 3" (76mm) top clearance and 1" (25mm) sides and bottom clearances for vent systems.

MINIMUM HORIZONTAL FRAMING DIMENSIONS		
VERTICAL RISE	VENT PIPE TOP (A)	FRAMED OPENING TOP (B)
12" (305mm)	51-1/4" (1.3m)	54-1/4" (1.38m)
18" (457mm)	57-1/4" (1.45m)	60-1/4" (1.53m)

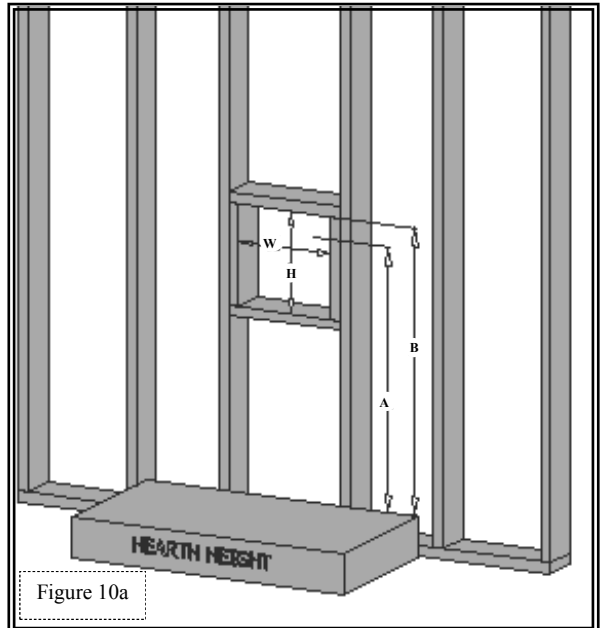

Figure 10a

CAUTION Cold air transfer area. The surrounding fireplace chase must comply with all clearances as outlined in this manual and be constructed in compliance with local building codes. Outside walls should be insulated to prevent cold air from entering room.

CAUTION Due to high temperatures, this fireplace should be located out of traffic areas and away from furniture and draperies.

FACING AND FINISHING

This fireplace was designed to accommodate non-combustible facing material up to 1/2" (13mm) thick. Install non-combustible facing material up to facing flange surrounding the glass frame assembly. Do not apply any material beyond this point. The glass frame assembly must be removable.

Non-combustible material is required at top and side of fireplace. Illustrations below reflect minimum non-combustible material dimensions.

Do not secure material to lower cover panel with screws, which may damage control system components. Use a silicone sealant that has a 300°F (149°C) continuous exposure rating to secure material in this zone.

It is acceptable to pre-drill holes and use self-tapping screws to attach non-combustible material to top and sides of fireplace face. Do not use excessively long screws.

WARNING Maintain minimum clearances to combustibles from fireplace and vent system.

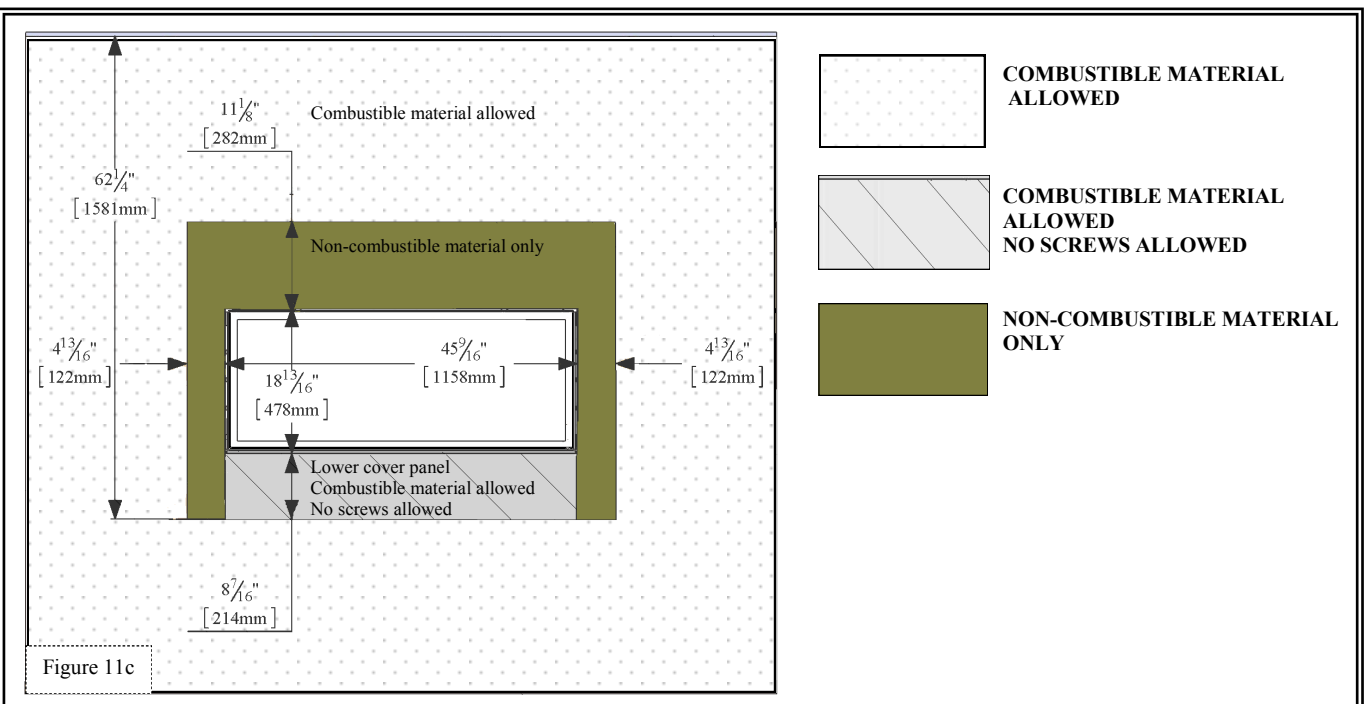
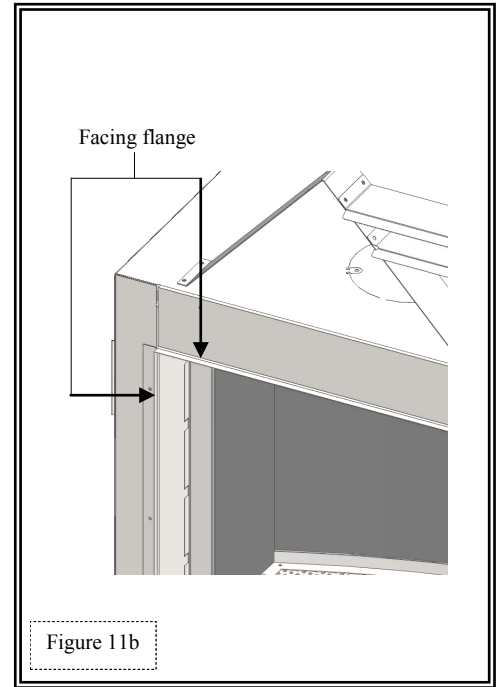
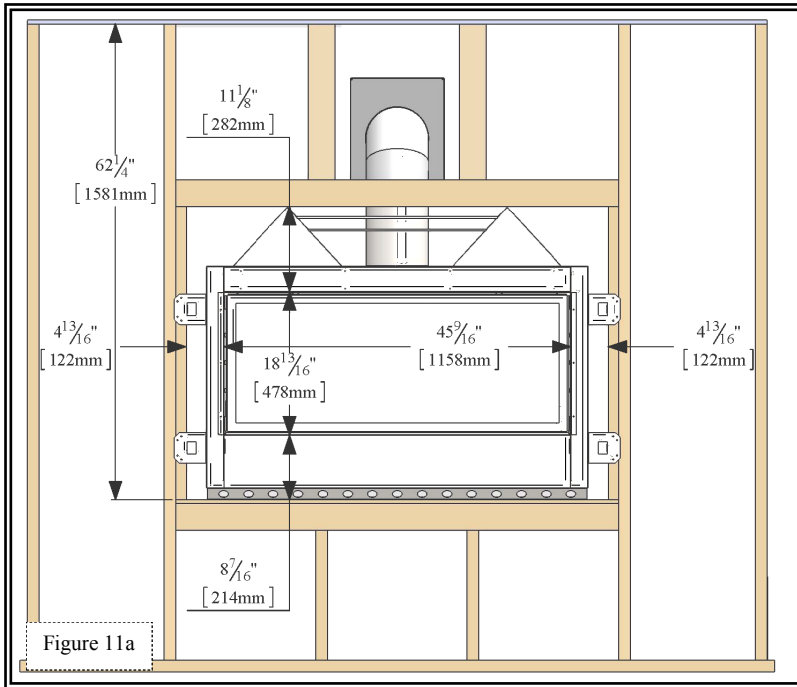

TYPICAL INSTALLATION OPTIONS

Kozy Heat wall pass-thru (#800-WPT or #800-WPT2) must be used on all horizontal vent runs. Follow instructions on page 16 of this installation manual.

IMPORTANT

The horizontal heat shield included with this fireplace must be installed when incorporating minimum horizontal venting. This applies to Nat. and LP minimum horizontal venting configurations.

Horizontal vent heat shield not shown in illustrations below for clarity purposes only.

HORIZONTAL INSTALLATION

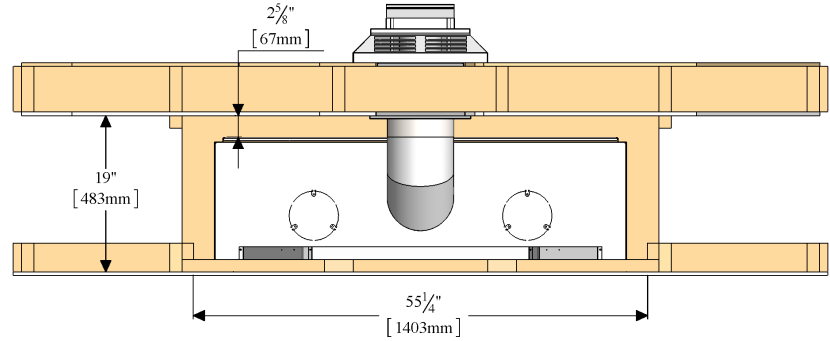

Figure 12a

VERTICAL INSTALLATION

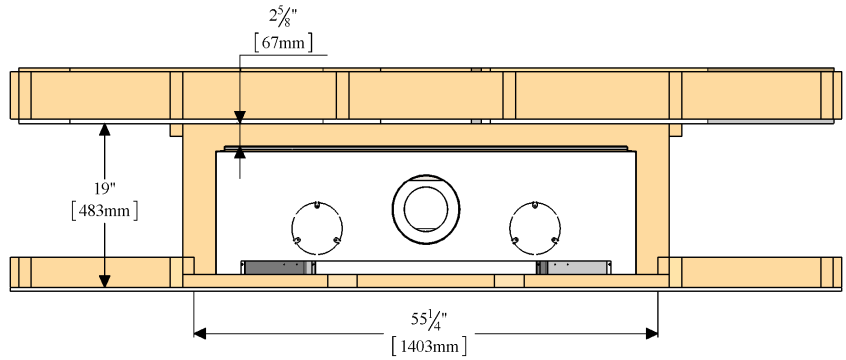

Figure 12b

CORNER INSTALLATION

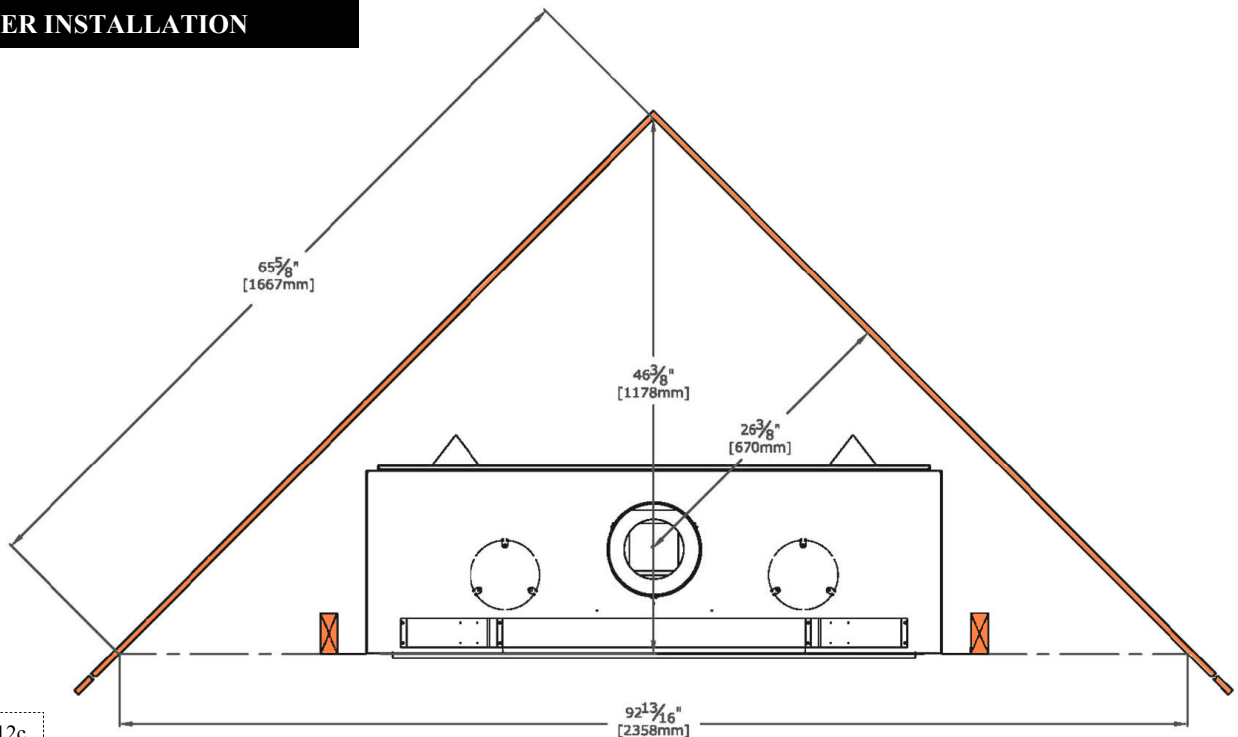
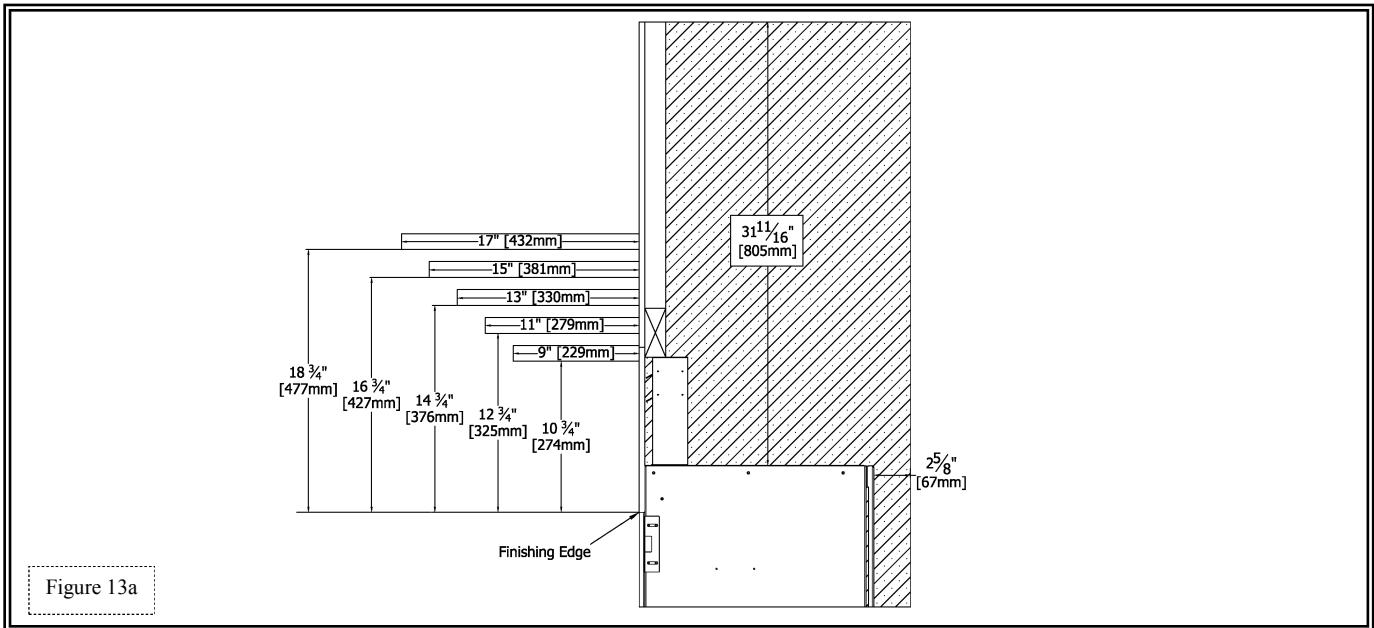

Figure 12c

MANTEL REQUIREMENTS

WARNING

Non-combustible zone: No combustible materials allowed on top of fireplace within shaded area for entire width and depth of fireplace with the exception of the header.



GLASS FRAME

WARNING

DO NOT OPERATE THIS FIREPLACE WITH THE GLASS FRONT REMOVED, CRACKED OR BROKEN. REPLACEMENT OF THE GLASS SHOULD BE DONE BY A LICENSED OR QUALIFIED SERVICE PERSON.

REMOVE GLASS FRAME ASSEMBLY

1. Open valve access cover by lifting front up, rotating towards glass frame.
2. Using a phillips head screwdriver, remove screws securing valve access cover (1 ea. side).
3. Loosen, but do not remove (2) wing nuts securing component upper heat shield. Pull component board forward (secured to hear shield with magnet) Remove heat shield.
4. Locate (2) spring loaded handles at bottom of firebox. Pull handles out and down to release.
5. Lift glass frame assembly up and off (2) tabs at top of firebox.

INSTALL GLASS FRAME ASSEMBLY

1. Place glass frame assembly top over tabs at top of firebox.
2. Pull bottom handles out and up to secure assembly bottom.
3. Reinstall component upper heat shield, secure with wing nuts, re-attach component board magnet to upper heat shield.
4. Reinstall valve access cover, using screws previously removed.

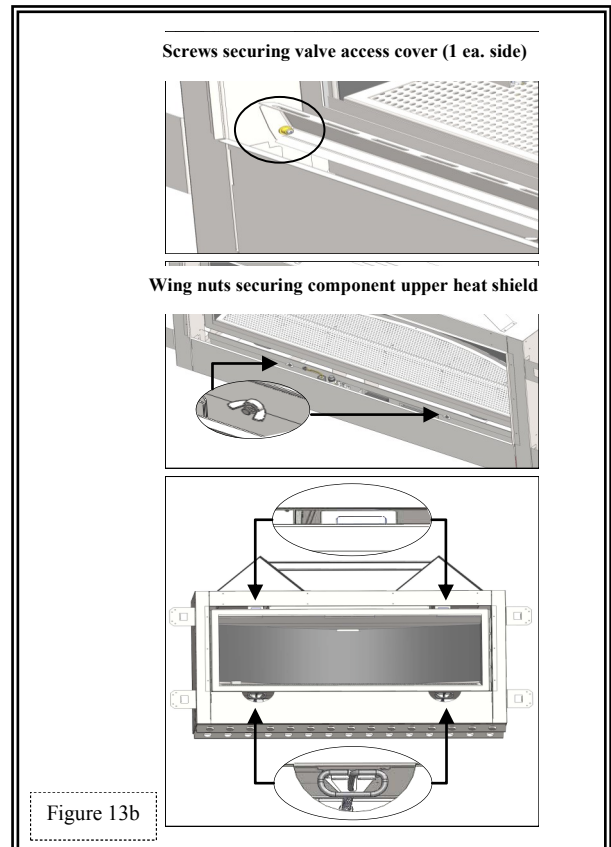

GAS LINE CONNECTION

GAS CONVERSION

This fireplace is manufactured for use with Natural Gas. Follow instructions included with conversion kit if converting to LP gas.

ATTENTION The conversion shall be carried out in accordance with the requirements of the provincial authorities having jurisdiction and in accordance with the requirements of the ANSI Z223.1 installation code.

CAUTION Installation of the gas line must only be done by a qualified person in accordance with local building codes, if any. If not, follow ANSI 223.1.
Commonwealth of Massachusetts: Installation must be done by a licensed plumber of gas fitter.

NOTE A listed (and Commonwealth of Massachusetts approved) 1/2" (13mm) T-handle manual shut-off valve and flexible gas connector (included) are connected to the 1/2" (13mm) control valve inlet. If substituting for these components, please consult local codes for compliance.

This fireplace is equipped with a 3/8"(10mm) x 18" (457mm) long flexible gas connector and manual shut-off valve. The gas line should be run to the point of connection where the shut-off valve and flexible gas line will connect.

The appliance and its individual shutoff valve must be disconnected from the gas supply piping system during any pressure testing of that system at pressures in excess of ½ psi (3.5 kPa).

The appliance must be isolated from the gas supply piping system by closing its individual manual shut-off valve during any pressure testing of the gas line at test pressures equal to or less than ½ psi (3.5 kPa).

For high altitude installations, consult the local gas distributor or the authority having jurisdiction for proper rating methods.

IMPORTANT The efficiency rating of this appliance is a product of thermal efficiency rating determined under continuous operating conditions and was determined independently of any installed system.

	NATURAL GAS	LP GAS
MINIMUM INLET GAS PRESSURE	5" WC (1.25 kPa) (7" WC (1.74 kPa) (recommended)	11" WC (2.74 kPa) (recommended)
MAXIMUM INLET GAS PRESSURE	10.5" WC (2.62 kPa)	13" WC (3.24 kPa)

ATTENTION **HIGH ALTITUDE INSTALLATIONS**

In the USA: The appliance may be installed at higher altitudes. Please refer to your American Gas Association guidelines which state: the sea level rated input of Gas Designed Appliances installed at elevations above 2000ft. (610m) is to be reduced 4% for each 1000ft. (305m) above sea level. Refer also to National Fuel Gas Code, ANSI Z223.1/NFPA 54, local authorities, or codes which have jurisdiction in your area regarding the de-rate guidelines.

In Canada: When the appliance is installed at elevations above 4500ft. (1372m), the certified high altitude rating shall be reduced at the rate of 4% for each additional 1000ft. (305m). Refer also to CSA-B149.1 Natural Gas and Propane Installation Code, Local authorities, or codes which have jurisdiction in your area regarding the de-rate guidelines.

VENTING

IMPORTANT Consult the local and national installation codes to assure adequate combustion and ventilation air is available.

This fireplace is designed to be used with any of the following vent systems without the use of an additional adaptor. Refer to vent manufacturer's installation manual for complete installation instructions. Installation must conform with venting requirements and restrictions as outlined in this manual.

Provide a means for visually checking vent connection to fireplace after fireplace is installed.

APPROVED VENTING

Simpson Dura-Vent DV-PRO 5" x 8" direct vent systems (horizontal and vertical terminations).

Selkirk Metalbestos 5" x 8" direct vent chimney system (horizontal and vertical terminations).

Kozy Heat #800 series flexible vent system (horizontal terminations).

Metal Fab 5" x 8" direct vent chimney system (horizontal and vertical terminations).

ICC 5" x 8" direct vent chimney system (horizontal and vertical terminations).

Security 5" x 8" direct vent chimney system (horizontal and vertical terminations).

Amerivent / American Metal 5" x 8" direct vent chimney system (horizontal and vertical terminations).

BDM 5" x 8" direct vent chimney system (horizontal and vertical terminations).

RLH 5" x 8" direct vent chimney system (vertical terminations).

HORIZONTAL VENT SYSTEM CLEARANCES

	TOP	BOTTOM	SIDES
ALL APPROVED VENTING	3 inches (76mm)	1 inch (25mm)	1 inch (25mm)

IMPORTANT Kozy Heat Wall Pass-thru, #800-WPT (4-1/2" (114mm) - 6-1/2" (165mm) wall thickness), or #800-WPT2 (6-1/2" (165mm) -12-1/2" (318mm) wall thickness) must be used on all horizontal vent runs.

IMPORTANT The horizontal heat shield included with this fireplace must be installed when incorporating minimum horizontal venting. This applies to Nat. and LP minimum horizontal venting configurations.
Flame height and appearance will vary depending upon venting configuration and type of fuel used.

HORIZONTAL TERMINATIONS (NAT GAS)

MINIMUM: 12" (305mm) vertical rise + 90° elbow + 9" (229mm) horizontal + termination cap.
(Horizontal Vent Heat Shield required).

MAXIMUM: 12" (305mm) vertical rise + 90° elbow + 12ft. (3.66m) horizontal + termination cap.
(Horizontal Vent Heat Shield required).

HORIZONTAL TERMINATIONS (LP GAS)

MINIMUM: 18" (457mm) vertical rise + 90° elbow + 9" (229mm) horizontal + termination cap.
(Horizontal Vent Heat Shield required).

MAXIMUM: 18" (457mm) vertical rise + 90° elbow / Max. 12ft. (3.66m) horizontal + termination cap.
(Horizontal Vent Heat Shield required).

VENTING

ELBOWS

The following statement applies to horizontal, vertical, or a combination of horizontal/vertical elbows:
For each additional 90° elbow used after first elbow, 3ft. (914mm) must be subtracted from maximum allowed venting. For each 45° elbow used, 1-1/2ft. (457mm) must be subtracted from maximum venting allowed.

NOTE (2) 45° degree elbows may be used in place of (1) 90° elbow..

#800-WPT WALL PASS-THRU

IMPORTANT #800-WPT or #800-WPT2 Wall Pass-Thru must be used on all horizontal vent terminations.
This includes both interior and exterior walls. Follow instructions below.

FRAMING DIMENSIONS FOR #800-WPT KOZY HEAT WALL PASS-THRU

12-1/2" (318mm) HIGH x 10-7/8" (276mm) WIDE

WARNING MAINTAIN ALL CLEARANCES AS STATED IN THIS INSTALLATION MANUAL.

IMPORTANT If using Kozy Heat series flexible vent system, remove inner ring on each wall pass-thru section with a tin snips.
This will provide adequate room for the flexible vent system.

- A. Measure wall thickness; cut insulation panel (included) this length.
- B. Install wall pass-thru section marked #1 (3/8" (10mm) flange) into framed opening. Secure to interior wall with screws (not provided).
- C. From the exterior, place insulation between flange and top of framed opening in wall pass-thru section #1.
- D. Install section marked #2 of wall pass-thru into framed opening, overlapping metal sections as necessary to accommodate wall thickness. Secure to exterior wall with screws (not provided).

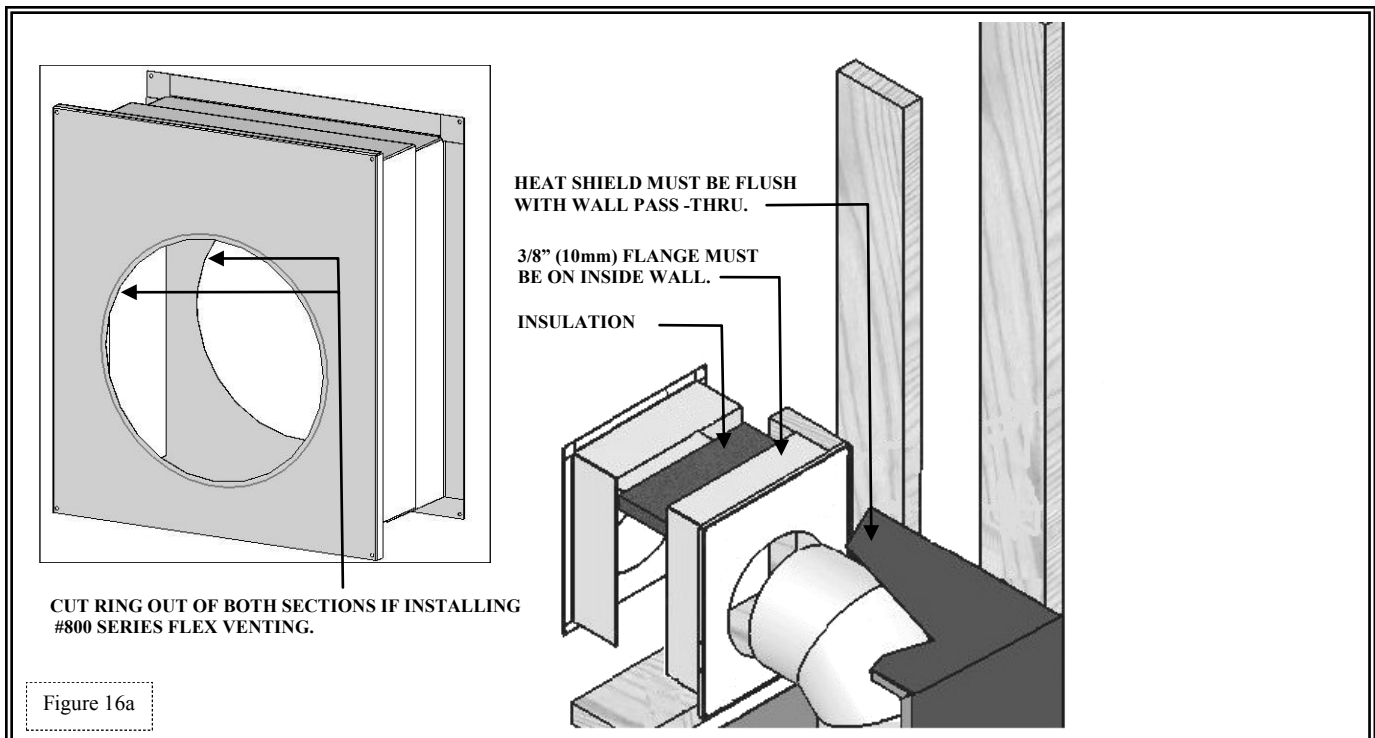
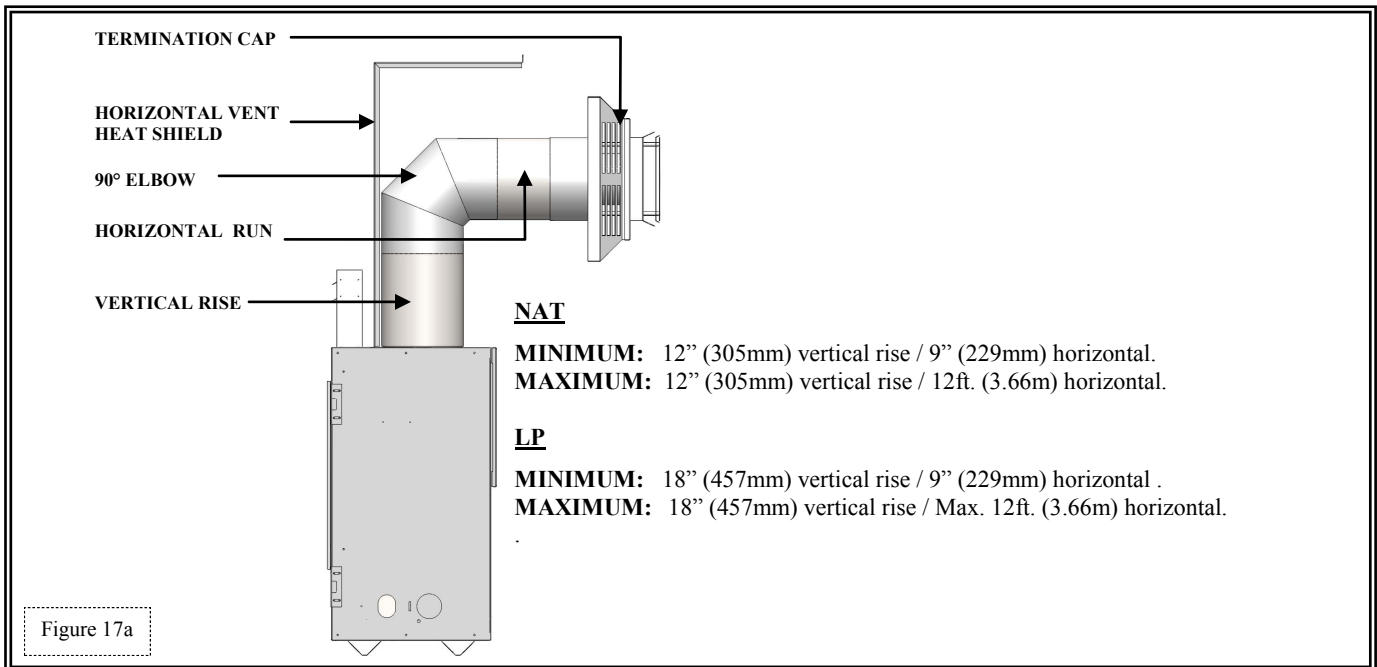

Figure 16a

VENTING

MIN. / MAX. HORIZONTAL VENTING



The horizontal vent heat shield included with this fireplace must be installed when incorporating minimum horizontal venting. This applies to Nat. and LP minimum horizontal venting configurations.

IMPORTANT

Kozy Heat Wall Pass-thru, #800-WPT (4-1/2" (114mm) - 6-1/2" (165mm) wall thickness), or #800-WPT2 (6-1/2" (165mm) -12-1/2" (318mm) wall thickness) must be used on all horizontal vent runs.

Flame height and appearance will vary depending upon venting configuration and type of fuel used.

HORIZONTAL VENT HEAT SHIELD

1. Loosen, but do not remove center two screws on top of fireplace.
2. Bend horizontal heat shield at perforation to a 90° angle. Slide (2) slots on horizontal vent heat shield under loosened screws.
3. Re-tighten screws.

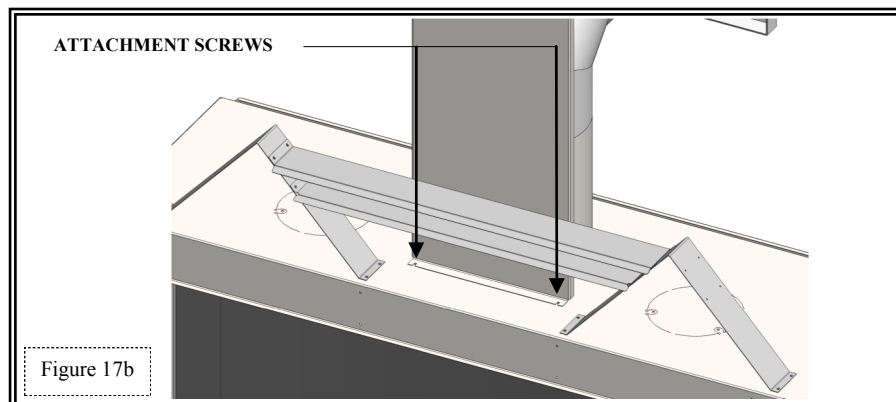

VENTING

VERTICAL VENT SYSTEM CLEARANCES

	TOP	BOTTOM	SIDES
ALL APPROVED VERTICAL PIPE	1 inch (25mm)	1 inch (25mm)	1 inch (25mm)

VERTICAL TERMINATIONS

NOTE

Horizontal Vent Heat Shield is not used on vertical venting configurations.

MIN. / MAX. VERTICAL VENTING

APPLIES TO NAT AND LP INSTALLATIONS:

MINIMUM: 2ft. (610mm) + cap.

MAXIMUM: 50ft. (15.24m) + cap.

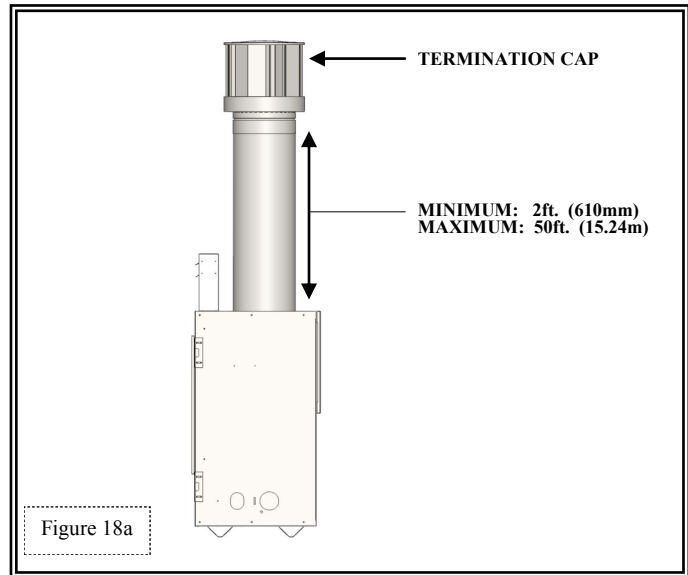

RESTRICTOR

Each installation is unique and affected by various factors including venting configuration, altitude and climate. Therefore, after fireplace installation is complete a restrictor (included with fireplace components packet) may be required or may need to be removed or modified.

Please refer below for installation instructions if installing the restrictor in conjunction with venting.

Page 27 has information on restrictor recommendations depending on burner flame appearance and instructions on installation after venting is completed.

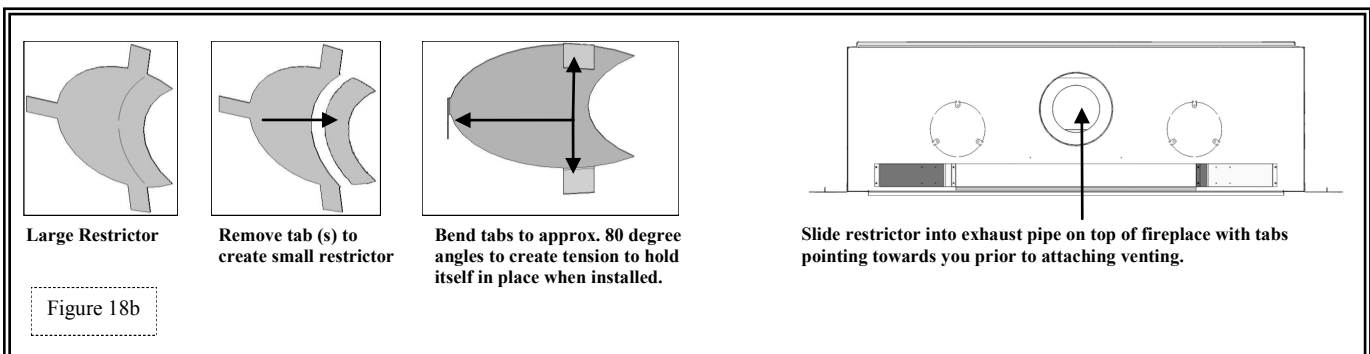

VENTING

ELBOWS

For each additional 90° elbow used after first elbow, 3ft. (914mm) must be subtracted from maximum allowed venting.

For each 45° elbow used, 1-1/2ft. (457mm) must be subtracted from maximum venting allowed.

(2) 45° degree elbows may be used in place of (1) 90° elbow.

The horizontal vent heat shield must be installed when using a 90-degree elbow to horizontally position the vent system.

Kozy Heat Wall Pass-thru, #800-WPT (4-1/2" (114mm) - 6-1/2" (165mm) wall thickness) or, #800-WPT2 (6-1/2" (165mm) - 12-1/2" (318mm) wall thickness), must be used on all horizontal vent runs.

Horizontal sections require 1/4" (6mm) rise for every 12" (305mm) of travel.

NOTE

Page 18 has information on restrictor installation in conjunction with venting installation. Page 27 has information on restrictor recommendations depending on burner flame appearance and instructions on installation after venting is completed.

CAUTION

This gas appliance must not be connected to or joined with any other chimney flue serving another appliance.

HORIZONTAL & VERTICAL COMBINATION VENTING

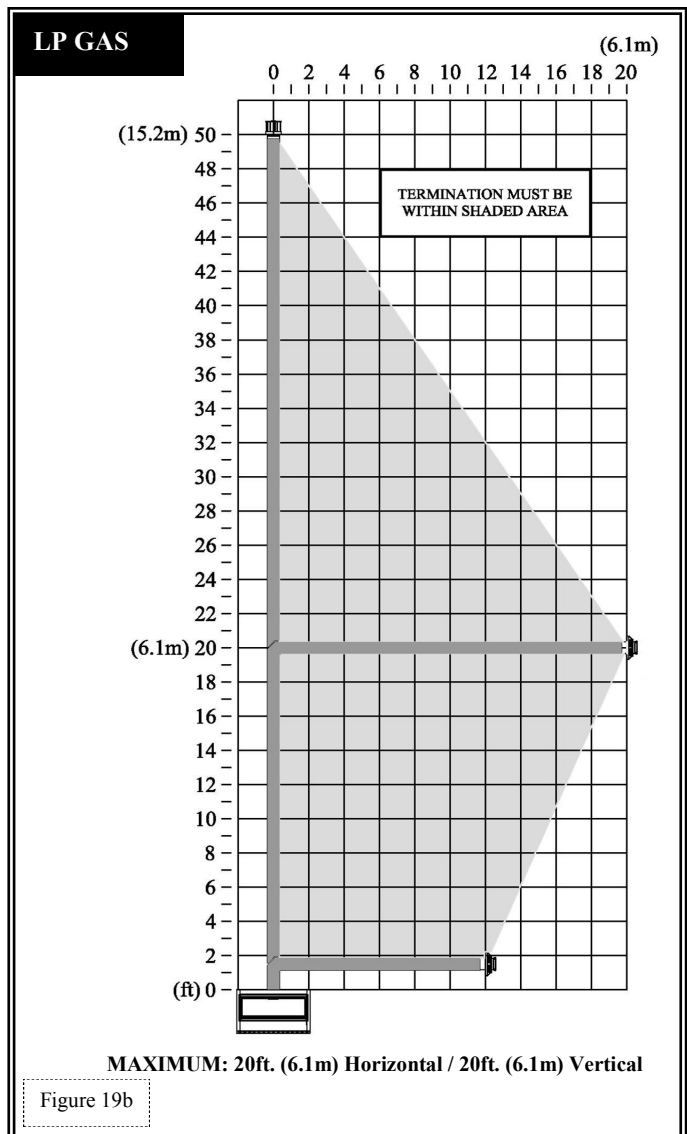
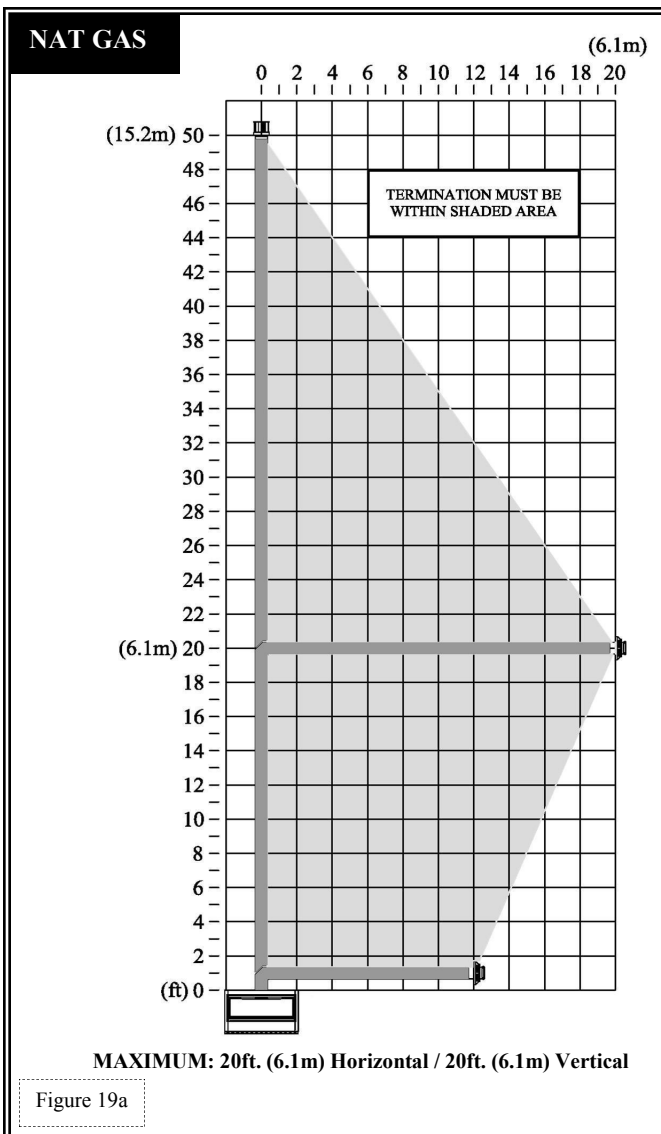

VENTING

INSTALLATION OF #800-1 SERIES DIRECT VENT TERMINATION KIT(S)

IMPORTANT

The flex pipe is permanently attached to the exterior plate. **DO NOT ATTACH #844-1 or #845-1 termination kit to fireplace (or extension kit) until it has passed through wall. Install termination plates to outside wall exterior.**

HORIZONTAL TERMINATIONS Refer to illustration on following page.

IF TERMINATING AGAINST VINYL SIDING, A VINYL SIDING PROTECTOR, INCLUDED WITH #844-1 AND #845-1 DIRECT VENT KITS, MUST BE USED. FOLLOW INSTRUCTIONS INCLUDED.

IMPORTANT

The Kozy Heat wall pass-thru, part #800-WPT or #800-WPT2, must be used on all horizontal vent applications regardless of which vent system you are using.

CAUTION

This gas appliance must not be connected to a chimney flu serving another type of appliance.

NOTE

Page 18 has information on restrictor installation in conjunction with venting installation. Page 27 has information on restrictor recommendations depending on burner flame appearance and instructions on installation after venting is completed.

1. If your vent system application does not require an extension kit, proceed to step #7.
2. If your vent system application will require one or more extension kits (Part #846-1), proceed with the following steps. Each #846-1 extension kit contains enough 5" & 8" flexible aluminum to extend chimney an additional 6ft. (1.83m).
3. Gently stretch 5" & 8" flexible aluminum pipes on termination kit (#844-1 or #845-1) and on each extension kit (if used) the length required for your installation.

IMPORTANT

DO NOT STRETCH EXTENSION KIT BEYOND 6ft. (1.83 m). DO NOT STRETCH BEYOND WHAT IS REQUIRED - IT IS VERY DIFFICULT TO RECOMPRESS FLEX PIPES ONCE STRETCHED.

4. Place a bead of sealant outside 5" flex pipe collar (C) (end with EXTERNAL lip), sliding it **inside** 5" pipe on top of fireplace (D). Secure with 3 evenly spaced screws.
5. Place a bead of sealant inside 8" flex pipe collar (E) (end with the INTERNAL lip), sliding it **over** 8" pipe on top of fireplace (F). Secure with 3 evenly spaced screws.
6. If additional extension kits are required, repeat steps #4 - #5, placing 5" & 8" pipes onto previous extension kit.
OPTIONAL: Place insulation between 8" pipe and wall studs.
7. With spacer legs toward the wall, slide interior firestop (H) over 8" pipe and attach to interior wall (over wall materials).

NOTE

Attachment brackets are included with termination kit. These optional brackets should be screwed or nailed (not provided) onto top and bottom of 9-1/2" (241mm) H x 9-1/2" (241mm) W opening on exterior of house. The termination plates then fit between these brackets. Using screws provided, secure brackets to termination box (A). Attach vinyl siding protector (G).

8. Apply a liberal bead of exterior sealant around outer edge of termination box (A), placing assembly through opening in exterior wall. Place screws through four slots (B), securing it in place.
9. Gently pull 5" & 8" pipes down to top of extension kit, or top of fireplace if no extension kits were used.
10. Place a bead of sealant outside 5" flex pipe collar (C) and slide it into 5" pipe on extension kit or top of fireplace (D). Secure with 3 evenly spaced screws.

ILLUSTRATION ON FOLLOWING PAGE.

VENTING

FLEXIBLE #800-1 SERIES cont.

A	TERMINATION BOX
B	SLOTS IN EXTERIOR WALL PLATE
C	5" FLEX PIPE COLLAR
D	5" PIPE ON FIREPLACE OR EXTENSION KIT
E	8" FLEX PIPE COLLAR
F	8" PIPE ON FIREPLACE OR EXTENSION KIT
G	VINYL SIDING PROTECTOR (not shown)
H	INTERIOR FIRESTOP

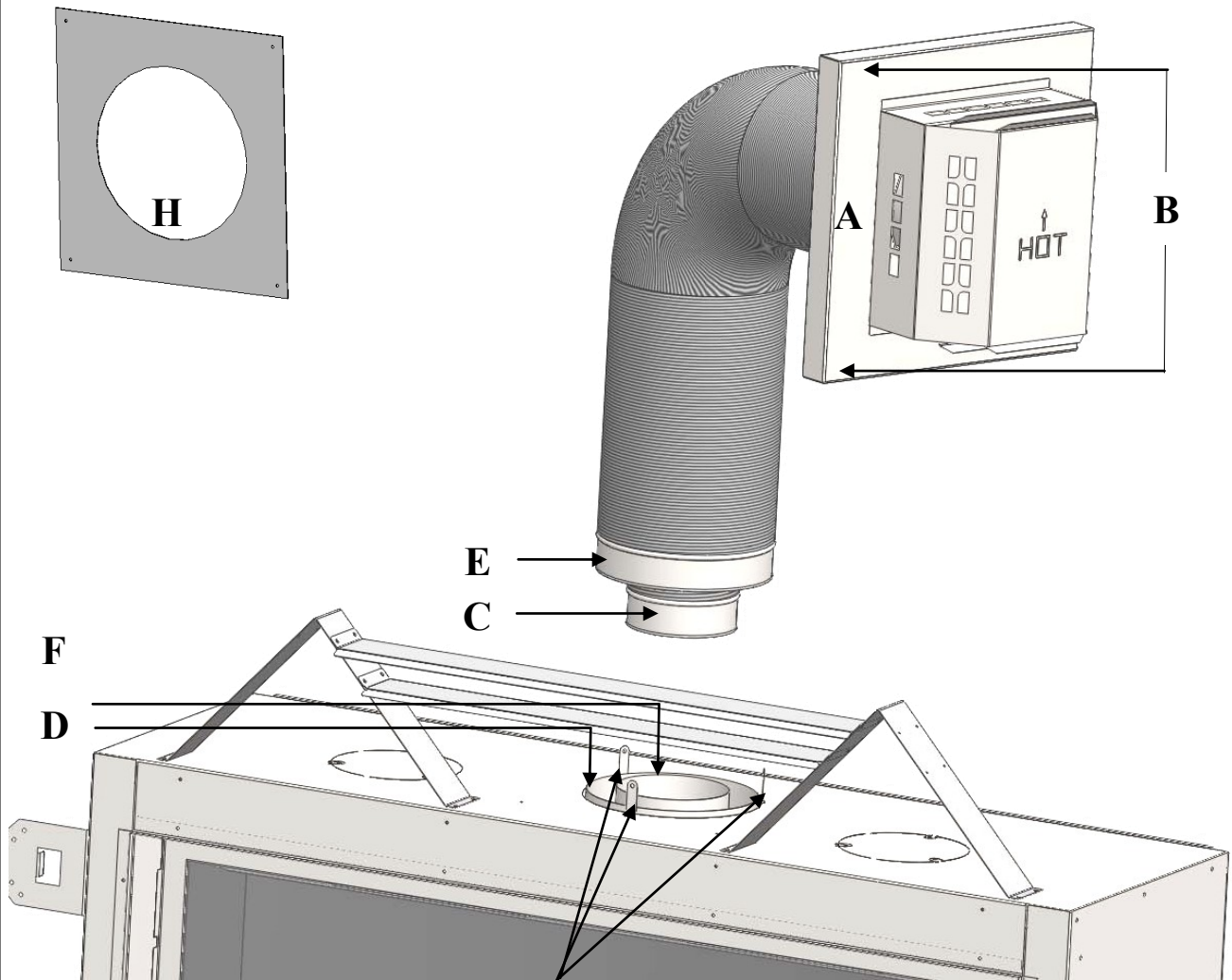

Bend tabs up before attaching 8" flex pipe collar. Secure pipe thru holes in tabs.

Figure 21a

NOTE

Horizontal vent heat shield not shown for clarity purposes only.

TERMINATION VENT CAP LOCATION

This gas appliance must not be connected to a chimney serving any other appliance.

1. Terminations against vinyl siding must use a vinyl siding protector. Follow instructions included.
2. **DO NOT RECESS TERMINATION KIT INTO OUTSIDE BUILDING MATERIALS** - i.e.: brick, stone, siding, etc. If necessary, extend framing so that termination kit will be exposed once building materials are installed.
3. Vent termination must not be located where it will become plugged by snow or other material. The flow of combustion and ventilation air must be not obstructed.

LOCATION CLEARANCES

- A. Above grade, veranda, porch, deck, balcony - 12" (305mm).
- B. Operable window or door - CANADA: 12" (305mm). US: 9" (229mm).
- C. Permanently closed window* - 12" (305mm) (recommended to prevent condensation on window).
- D. Ventilated soffit* - 24" (610mm).
- E. Unventilated soffit* - 12" (305mm).
- F. Outside corner* - 12" (305mm).
- G. Inside corner* - 6" (152mm).
- H. Meter / Regulator: CANADA: Not to be installed above a gas meter/regulator assembly within 3ft. (914mm) horizontally from the centerline of the regulator within a height of 15ft. (4.57m). US*.
- I. Gas Service regulator vent outlet : CANADA: 3ft. (914mm). US*.
- J. Non-mechanical air supply inlet to building or the combustion air inlet to any other appliance. CANADA: 12" (305mm). US: 9" (229mm).
- K. Mechanical air supply inlet. CANADA: 6ft. (1.83m) US: 3ft. (914mm) above if within 10ft. (3.05m) horizontally. Massachusetts installations: 10ft. (3.05m).
- L. Above paved side-walk or paved driveway located on public property - 7ft. (2.13m). US*.

NOTE

A vent cannot be located directly above a side-walk or paved driveway that is located between two single family dwellings and serves both dwellings.

- M. Under veranda, porch, deck, or balcony (must be fully opened on a min. of 2 sides) - 12" (305mm).
- N. Between two horizontal terminations - 12" (305mm).
- O. Between two vertical terminations - 12" (305mm). Terminations may be the same height.
- P. Above furnace exhaust or inlet - 12" (305mm).

*Clearance must be in accordance with local installation codes & the requirements of the gas supplier.

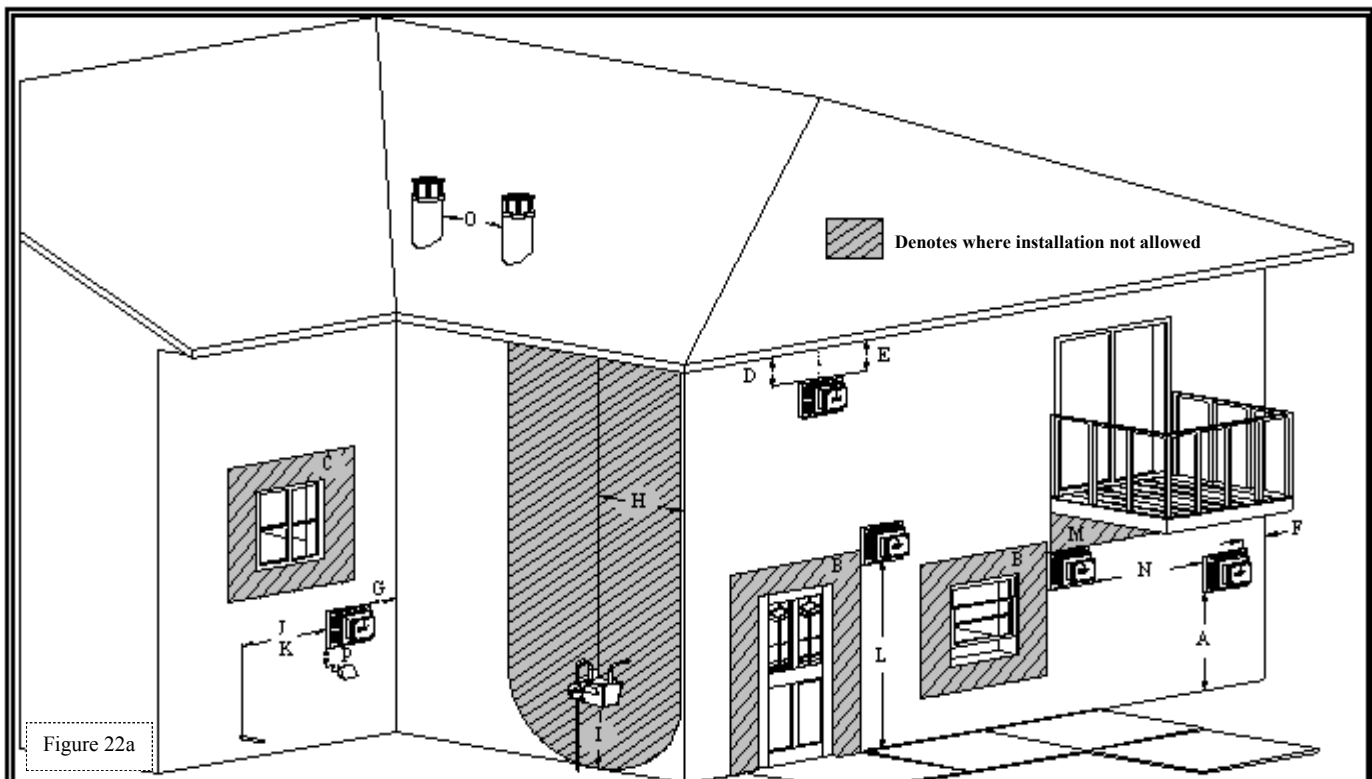

VENTING (Vertical Cap Requirements)

VENT TERMINATION CLEARANCES

Roof Pitch	H (Min.) Ft.	H (Min.) m
Flat to 6/12	1.0	0.30
Over 6/12 to 7/12	1.25	0.38
Over 7/12 to 8/12	1.5	0.46
Over 8/12 to 9/12	2.0	0.61
Over 9/12 to 10/12	2.5	0.76
Over 10/12 to 11/12	3.25	0.99
Over 11/12 to 12/12	4.0	1.22
Over 12/12 to 14/12	5.0	1.52
Over 14/12 to 16/12	6.0	1.83
Over 16/12 to 18/12	7.0	2.13
Over 18/12 to 20/12	7.5	2.27
Over 20/12 to 21/12	8.0	2.44

CAUTION

This appliance must not be connected to or joined with any chimney flue serving any other appliance.

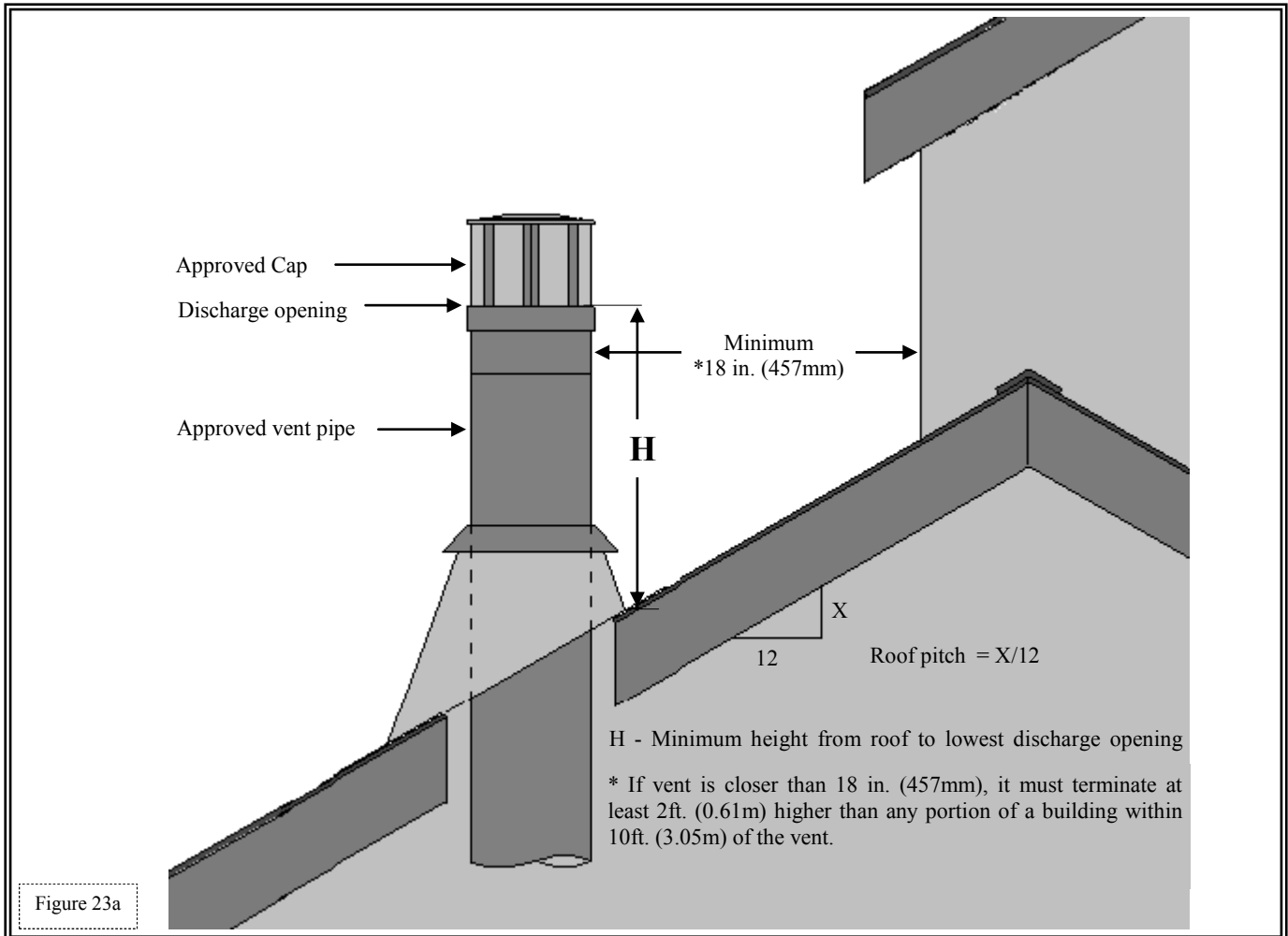

LIGHT KIT

ATTENTION

If converting to LP (propane) gas, do so now before installing light kit components. Follow instructions included with conversion kit (sold separately).

CAUTION

Disconnect all electric power from fireplace before performing this task.

NOTE

To avoid damage and prolong the life of halogen bulbs, never touch with bare hands. Always use a soft cloth when handling.

1. Remove glass valance assembly. Page 13.
2. Remove (10) screws securing burner cover, lift cover out of firebox.
3. Install (6) halogen bulbs (included in components packet) into lamp bases.
4. Reinstall burner cover, securing with screws previously removed.

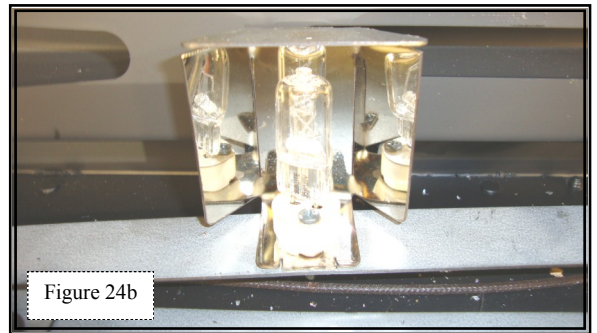
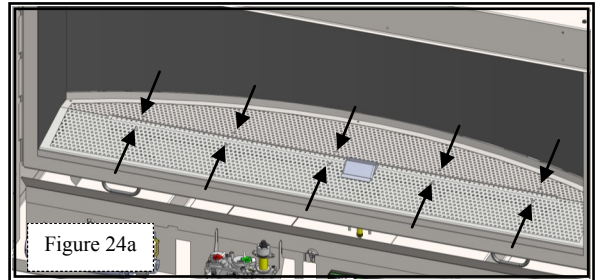

GLASS MEDIA INSTALLATION (sold separately)

WARNING

USE ONLY #101 SERIES GLASS MEDIA (10 lbs. / 4.5 kg) IN THIS FIREPLACE.

DO NOT SUBSTITUTE MATERIALS OR USE MORE THAN SPECIFIED.

DO NOT BLOCK PILOT ASSEMBLY WITH GLASS MEDIA!! A BLOCK PILOT MAY CAUSE DELAYED IGNITION!!

GLASS MEDIA MUST BE NO MORE THAN ONE LAYER DEEP ACROSS ENTIRE BURNER / SCREEN AREA TO AVOID POSSIBLE DELAYED IGNITION AND/OR SOOTING ISSUES.

Install glass media onto burner assembly and pilot shield, being careful not to block pilot assembly.

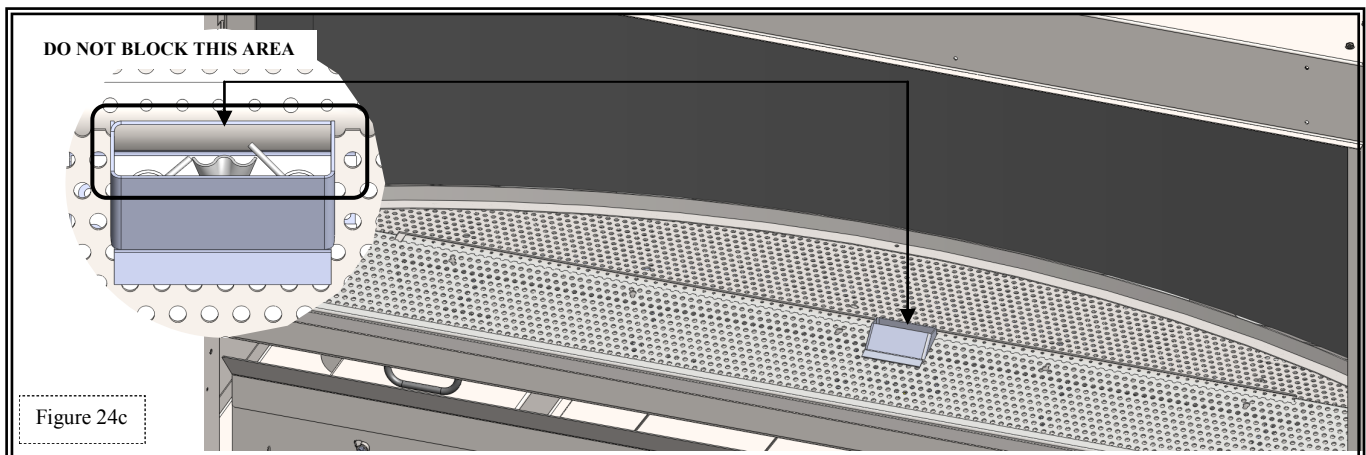

CONTROL BOARD REMOVAL / INSTALLATION

CAUTION

If burner and/or pilot have been burning, use appropriate protection to avoid burns or damage to personal property before removing any components.

WARNING

DO NOT OPERATE THIS FIREPLACE WITHOUT SEALING GASKET (LOCATED UNDER CONTROL BOARD) IN PLACE. IF GASKETING IS DAMAGED, IT MUST BE REPLACED.

REMOVAL

1. Use remote to turn fireplace off.
2. Remove glass frame assembly.
3. Shut off gas supply at manual shut-off valve.
4. Disconnect gas line flex tube from manual shut-off valve.
5. Unplug all components from receptacle, disconnect all wiring harnesses attached to gas valve.
6. Remove glass media.
7. Remove burner cover (secured with (10) screws).
8. Remove burner venturi housing. Remove burner tube from mounting cradles.
9. Remove (2) nuts securing light bar to control board, carefully move light bar backwards far enough to clear board.
10. Remove (8) screws securing control board, lift board out of firebox being careful not to damage sealing gasket lying underneath.

INSTALLATION

1. Place control board in firebox, aligning holes in board to holes in firebox bottom. **MAKE SURE SEALING GASKET IS IN PLACE ON FIREBOX BOTTOM!** Secure with (8) screws previously removed.
2. Reinstall light bar onto control board, secure with (2) nuts previously removed.
3. Reinstall burner, positioning burner venturi over burner orifice, aligning burner tube with mounting cradles on control board. Re-install burner venturi housing.
4. Reinstall burner cover, aligning holes in cover to corresponding holes in burner tube mounting cradles. Secure with screws (10).
5. Reinstall glass media, being careful not to block pilot.
6. Reconnect gas line to manual shutoff valve.
7. Reconnect all wiring harnesses to gas valve, Plug all components into electrical outlet.
8. Reinstall glass frame assembly.
9. Turn gas on.
10. Verify proper glass media placement, operation of fireplace, and any electrical components.

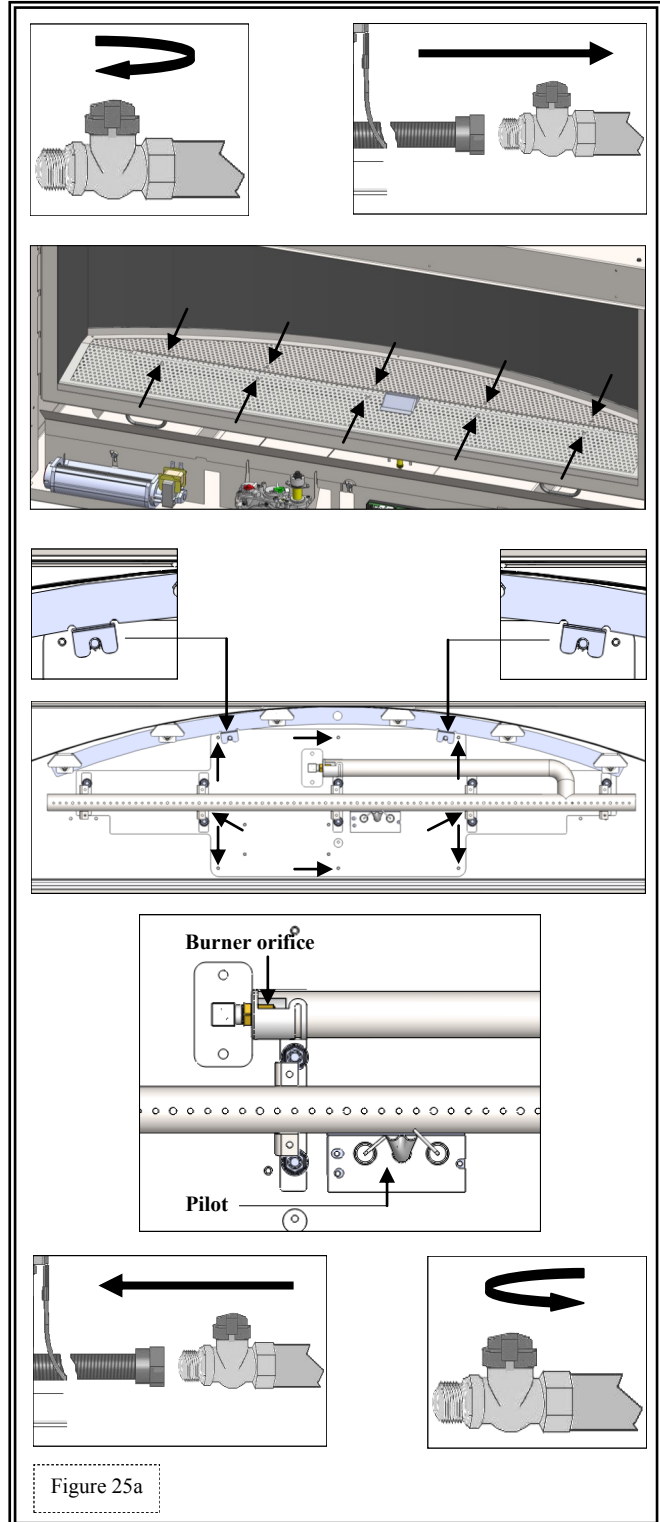

CAUTION

CHECK ALL CONNECTIONS FOR LEAKS WITH SOAPY WATER, WHETHER FIELD OR FACTORY MADE.

FINALIZING THE INSTALLATION

FLAME APPEARANCE:

Flame appearance is affected by several factors including altitude, venting configuration and fuel quality. Although the venturi setting has been factory set, adjustments may be necessary for optimal performance and visual aesthetics.

When fireplace is first lit, the flames will be blue. Flames will gradually turn yellowish-orange during first 15 minutes of operation. If flames remain blue, or become dark orange with evidence of sooting (black tips), the burner tube venturi may need adjustment.

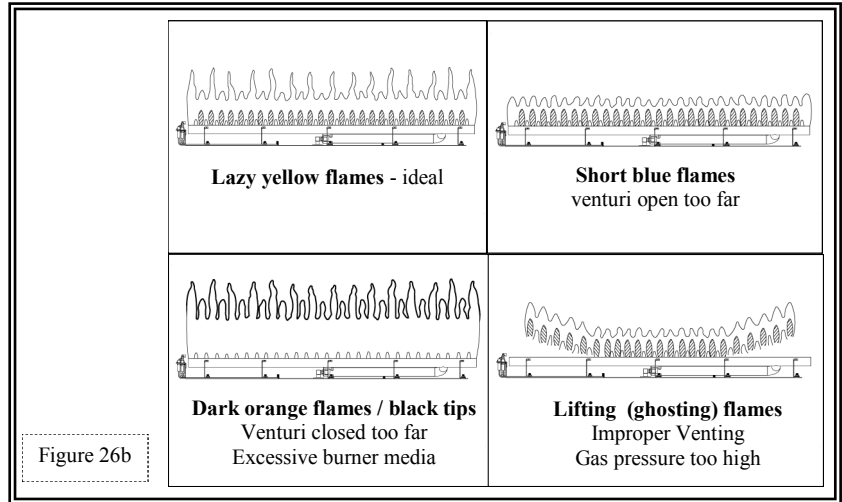
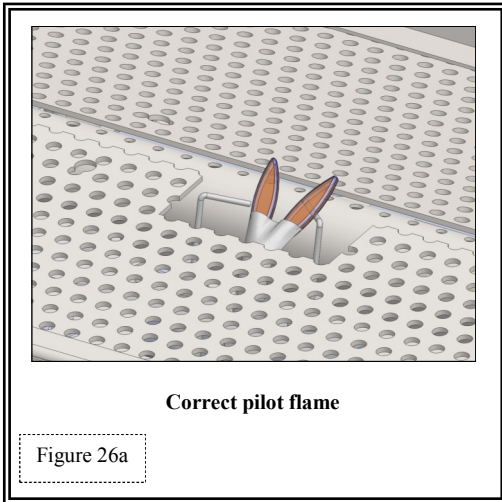

WARNING

BURNER TUBE ADJUSTABLE VENTURI POSITIONING SHOULD ONLY BE PERFORMED BY A QUALIFIED PROFESSIONAL SERVICE TECHNICIAN.

FACTORY SET BURNER TUBE VENTURI SETTINGS (ADJUST AS NECESSARY FOR YOUR INSTALLATION)

NATURAL GAS	LP (PROPANE) GAS
1/8" (3mm) OPEN	5/8" (16mm)

BURNER TUBE VENTURI ADJUSTMENT GUIDELINES

VENTURI POSITION	FLAME COLOR	VENTURI ADJUSTMENT
Closed too far	Dark orange flame with black tips	Open venturi setting slightly
Open too far	Blue flames	Close venturi setting slightly

IMPORTANT

SLIGHT ADJUSTMENTS TO BURNER VENTURI OPENING CREATE DRAMATIC RESULTS. ADJUST AT SLIGHT INCREMENTS UNTIL DESIRED LOOK IS ACHIEVED. ALWAYS BURN FIREPLACE FOR AT LEAST 15 MINUTES AND ALLOW TIME TO COOL BEFORE MAKING ANY FURTHER ADJUSTMENTS.

TO ADJUST VENTURI:

WARNING

To avoid property damage or personal injury, allow fireplace ample time to cool before making any adjustments.

1. Remove glass frame assembly, glass media, burner venturi housing, burner cover and burner from fireplace.
2. Loosen burner venturi screw, make adjustment, retighten screw.
3. Re-install burner, making sure venturi is positioned over burner orifice. Re-install burner venturi housing.
4. Reinstall burner cover, glass media, and glass frame assembly.
5. Light fireplace. Wait at least 15 minutes before determining if any further adjustments are necessary.

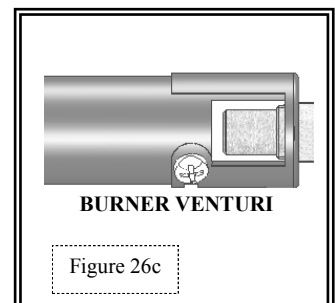

FINALIZING THE INSTALLATION

RESTRICTOR USAGE:

Turn fireplace on and allow to burn for 15 minutes.

If flames indicate there is excessive draft (flickering, short flames), a restrictor may be necessary.

If flames indicate insufficient draft (lifting or ghosting flames), a previously installed restrictor may need to be modified or removed.

WARNING

TO AVOID PROPERTY DAMAGE OR PERSONAL INJURY, ALLOW FIREPLACE AMPLE TIME TO COOL BEFORE MAKING ANY ADJUSTMENTS AND / OR INSTALLATIONS.

RESTRICTOR TROUBLESHOOTING

FLAME APPEARANCE	DRAFT PROBLEM	RESTRICTOR SOLUTION
Short, flickering	Excessive draft - not enough restriction	Add restrictor
Lifting or ghosting*	Insufficient draft - too much restriction	Remove inner ring (s) on restrictor or remove restrictor

* Improper venting installation may cause flames to lift or “ghost” - a dangerous situation. Inspect flames after installation to ensure proper performance. If determined that venting is correct, and the restrictor has been removed, yet flames are still lifting or ghosting, shut off gas supply to fireplace and call a qualified service technician.

RESTRICTOR INSTALLATION / MODIFICATION (after termination completion):

If it is determined that a restrictor is needed or restrictor modification is required after termination is installed, access can be reached through the fireplace baffle.

1. Remove glass frame assembly. Page 15.
2. Remove (2) screws securing termination access panel. Release panel tabs from slots in baffle.
3. Depending on your specific needs, determined by chart above along with other factors, make necessary modifications.
4. If installation of a restrictor (included in fireplace components packet) is necessary, bend tabs on restrictor to approx. 80 degree angles to create tension when inserted into exhaust pipe on fireplace. Insert restrictor into 5” exhaust pipe with tabs pointing towards you.
5. If modification is necessary, remove restrictor by pulling it down and out of 5” exhaust pipe.
6. Reinstall termination access panel, inserting tabs in panel into slots in baffle. Secure with (2) screws previously removed.
7. Re-install glass frame assembly and light fireplace. Wait 15 minutes before determining if any further modifications are necessary.

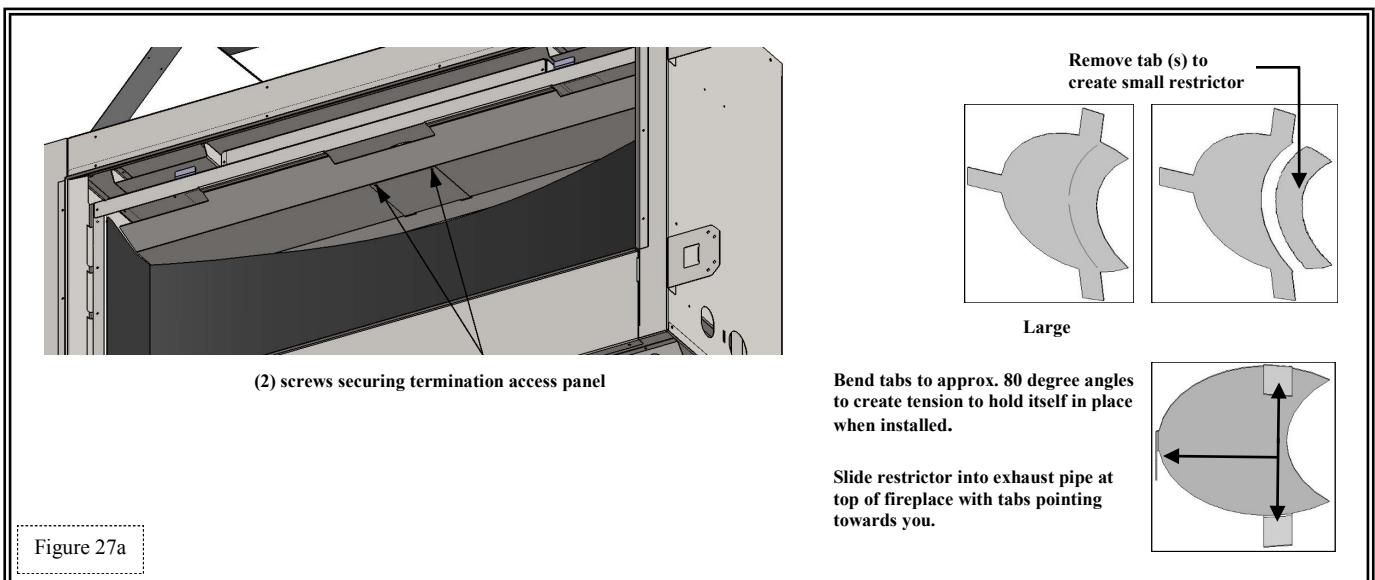

MAINTENANCE

The appliance is required to be inspected at least once a year by a professional service person.

The compartment below firebox must be cleaned at least once a year, more frequent cleaning may be required due to excessive lint from carpeting, bedding materials, or other fibrous materials. Use a vacuum to clean all components at least once a year.

NOTE

INSTALLATION AND REPAIR SHOULD BE DONE ONLY BY QUALIFIED SERVICE PERSON. THE APPLIANCE SHOULD BE INSPECTED BEFORE USE AND ANNUALLY BY A QUALIFIED SERVICE PERSON. MORE FREQUENT CLEANING MAY BE REQUIRED DUE TO EXCESSIVE LINT FROM CARPETING, BEDDING MATERIALS, ETC. IT IS IMPERATIVE THAT CONTROL COMPARTMENTS, BURNERS AND CIRCULATION AIR PASSAGEWAYS OF THE APPLIANCE BE KEPT CLEAN.

CONTROL BOARD SYSTEM

- Annual cleaning of the burner system is required. Vacuum all components thoroughly.
- The burner assembly may be removed for easier access. Refer to page 25 in this installation manual for complete instruction on removing & reinstalling the burner assembly.
- Visually check for blocked port holes, especially near the pilot. Blocked port holes may cause delayed ignition.
- Reinstall burner assembly following instructions on page 25 of this installation manual.
- Visually check pilot light and burner when in operation. The flames should be steady, not lifting or floating.

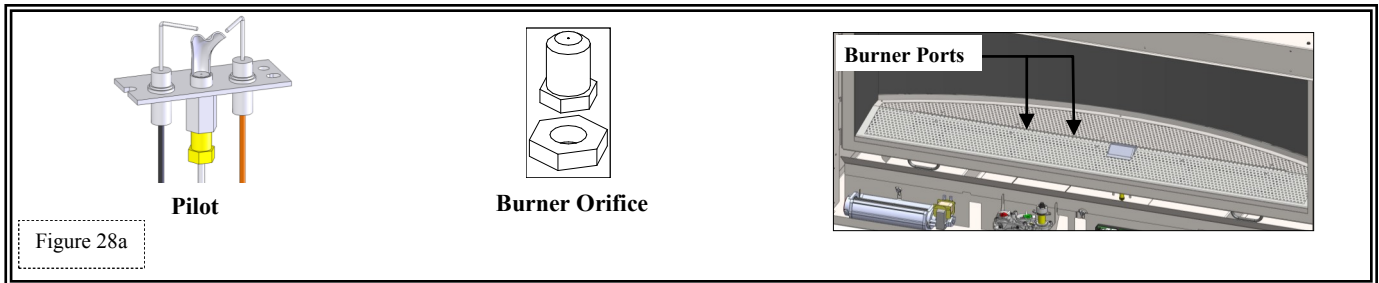

FAN

The fan should be disconnected from electrical current, and cleaned (vacuumed) every six months. The bearings are sealed and require no oiling.

VENT SYSTEM

Annual examination of venting system by a qualified agency is required.

IF VENT-AIR INTAKE SYSTEM IS DISASSEMBLED FOR ANY REASON, RE-INSTALL PER INSTRUCTIONS PROVIDED WITH INITIAL INSTALLATION.

The flow of combustion and ventilation air must not be obstructed.

GLASS CLEANING & REPLACEMENT

- Clean glass only when cool and only with non-abrasive cleansers.
WARNING: DO NOT OPERATE APPLIANCE WITH GLASS/FRAME ASSEMBLY REMOVED, CRACKED OR BROKEN. REPLACEMENT OF THE GLASS SHOULD ONLY BE PERFORMED BY A LICENSED OR QUALIFIED SERVICE PERSON.
- Use protective gloves to handle any broken or damaged glass assembly components.
- The glass assembly, part #SL42-057T, shall only be replaced as a complete unit, as supplied by Hussong Mfg. Co., Inc.
- Replacement of glass & frame assembly, part #SL42-057T, must only be performed by a licensed or qualified service person.
DO NOT SUBSTITUTE MATERIALS.
- Do not strike or slam glass door assembly.

IMPORTANT

ANY SAFETY SCREEN OR GUARD REMOVED FOR SERVICING MUST BE REPLACED PRIOR TO OPERATING THE APPLIANCE.

CAUTION

LABEL ALL WIRES PRIOR TO DISCONNECTION WHEN SERVICING CONTROLS. WIRING ERRORS CAN CAUSE IMPROPER AND DANGEROUS OPERATION. VERIFY PROPER OPERATION AFTER SERVICING.

KEEP APPLIANCE AREA CLEAR OF COMBUSTIBLE MATERIALS, SUCH AS GASOLINE AND OTHER FLAMMABLE VAPORS AND LIQUIDS.

#970 HEAT DUCT KIT INSTRUCTIONS

CAUTION

Read and follow instructions carefully prior to and during installation of this optional heat duct kit

WARNING

INSTALLATION OF THIS DUCT KIT & ELECTRICAL WIRING MUST BE PERFORMED BY A QUALIFIED SERVICE PERSON AND IN ACCORDANCE WITH LOCAL CODES, OR IN THE ABSENCE OF LOCAL CODES, WITH THE NATIONAL ELECTRICAL CODE, ANSI/NFPA 70, OR THE CANADIAN ELECTRICAL CODE, CSA C22.1.

DO NOT SUBSTITUTE THE FLEXIBLE HEAT DUCT PIPE WITH PLASTIC VENT PIPE!

This kit includes:

- | | |
|--|-----------------------------|
| (1) 6" (152mm) diameter flexible heat duct pipe, expandable to 20ft. (6.10m) | (2) Mounting bracket screws |
| (1) Register mounting frame with collar | (11) Sheet metal screws |
| (1) Register cover with screws | (4) Sheet rock screws |
| (1) Duct collar | (3) Flange nuts |
| (1) Fan assembly | (1) Strapping cord |
| (1) Fan housing cover plate | (3) Wire nuts |
| (1) Speed control mounting bracket | (2) Fan wire connectors |
| (1) Speed Control | |

A junction box, cover, and hardware must be purchased to mount speed control.

SPECIFICATIONS

Clearance to combustibles: 0" (0mm)

Clearance from air duct to ceiling: 2" (51mm)

Minimum vent run: 2ft. (609mm)

Maximum vent run: 20ft. (6.10m) in any direction including downward.

The fireplace is manufactured with (2) heat duct knock-outs. One or both may be utilized.

The register mounting frame is designed to fit between 2" x 4" stud walls, 16" (406mm) on center.

Oval duct pipe (equivalent to 6" round) may be used in conjunction with 6" (152mm) diameter flexible heat duct pipe included with this kit. It must be purchased from a HVAC supplier.

Carefully plan location of duct pipe runs and register in relation to fireplace. Refer to illustration below.

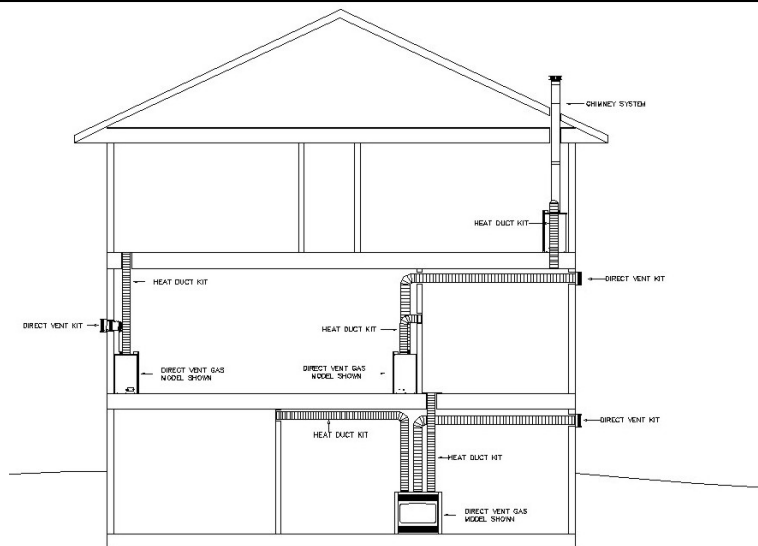

Figure 29a

#970 HEAT DUCT KIT INSTRUCTIONS

PREPARE THE FIREPLACE

1. Remove one 6" diameter knock-out located at top of fireplace. If both heat ducts will be used, remove both knock-outs.
2. Bend 3 tabs up & out far enough to allow duct collar & duct pipe installation.
3. For each 6" knock-out removed in step1, remove knock-out located directly below previously removed knock-out.



Figure 30a



4. Slide duct collar, with circulation holes facing downward, into 6" knock-out until it rests on top of heat shield.



Figure 30b

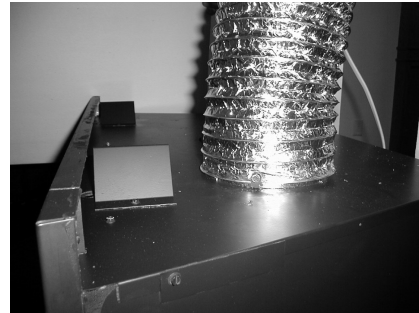

ATTACH DUCT PIPE TO FIREPLACE

1. Slide 6" (152mm) duct pipe (s) over collar (s) until resting on top of fireplace.
2. Bend tabs up and over duct pipe. Using included screws, secure duct pipe to collar thru holes in tabs, making sure screws penetrate thru both duct pipe and collar.
3. Position fireplace.

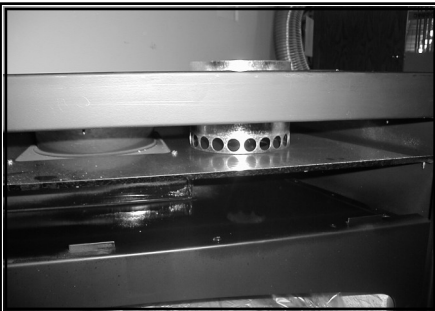

Figure 30c

#970 HEAT DUCT KIT INSTRUCTIONS

INSTALL REGISTER MOUNTING FRAME, JUNCTION BOX, RUN WIRING

Register mounting frame and fan housing are designed to fit between 2" x 4" stud walls, 16" (406mm) on center. Additional framing is required if larger opening exists.

NOTE

Fan motor on heat duct kit may be on opposite side of fan shown in photos.
Romex connector and grounding screw are located on motor side of bracket.

1. Locate and mark register position.
2. Place register mounting bracket into opening.
 - A. Level and adjust mounting bracket. Side of mounting bracket should be flush with front of studs, front of mounting bracket should protrude 1/2" (13mm) in front of studs, allowing enough room for sheetrock installation.
 - B. Secure mounting bracket to framing with (4) sheetrock screws, provided.
3. Install junction box on wall in desired location. This box will be used to house the speed control assembly, which controls fan speed and operation.
4. Attach (but do not tighten) flange nuts to mounting studs at back of register mounting bracket.
5. Align (3) slots on fan assembly to studs, slide fan into position. Tighten nuts to secure.
6. Slide fan wire connectors, included, onto fan terminals.
7. Properly wire the 110 VAC wire to the hot & neutral fan wires and speed control wires with the wire nuts provided. Run 110 VAC to fan speed control, then from fan speed control through the romex connector on the register bracket. Secure grounding wire to the grounding screw installed in register mounting bracket.

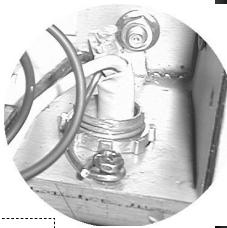
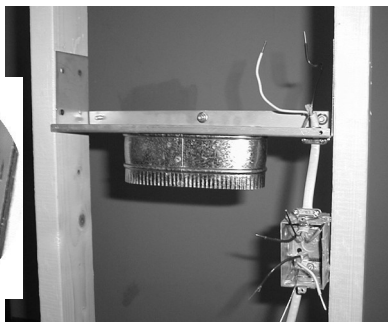

Figure 31a



IMPORTANT

Fan must be properly grounded. Use grounding screw (provided) to secure grounding wire to register mounting bracket.

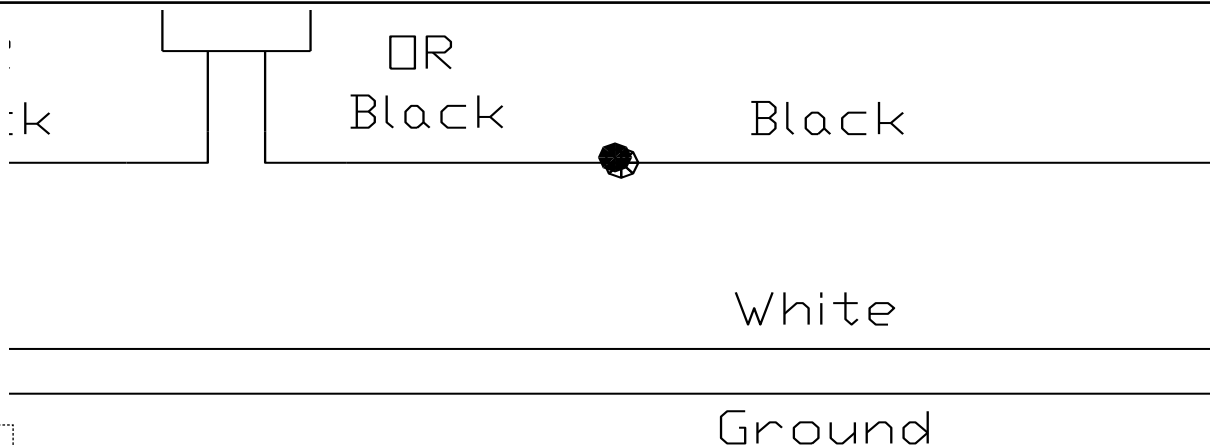

Figure 31b

#970 HEAT DUCT KIT INSTRUCTIONS

RUN DUCT PIPE

1. Run duct pipe to register location. If oval pipe will be used in conjunction with 6" (152mm) round duct pipe, shape round duct pipe to fit **outside** oval duct pipe. Secure with screws provided.
 2. If oval duct pipe has not been used, shape 6" (152mm) round duct pipe so it fits **outside** oval collar on register mounting bracket.
 - A. Slide duct pipe over oval collar until it touches register mounting bracket.
 - B. Secure duct pipe to oval collar by placing locking strap around pipe, positioning it above bead on lower end of collar. (This will prevent pipe and locking strap from sliding off collar.)
 - C. Pull locking strap tight enough to firmly secure duct pipe.
- OPTIONAL: Duct pipe may be secured with additional screws (provided).
3. If oval duct pipe has been used, slide duct pipe over oval collar on register mounting bracket, secure with sheet metal screws provided.

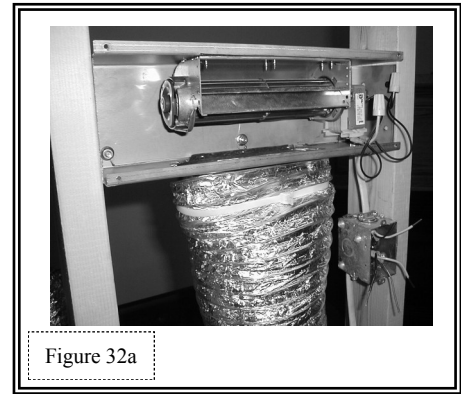

Figure 32a

COMPLETE THE INSTALLATION

1. Install sheetrock or wall finish material as desired before attaching register cover and fan housing cover plate.
2. With cut-out portion over fan chute, align holes in fan housing cover plate to corresponding holes in register mounting plate and fan assembly. Secure with (4) screws provided.
3. Slide speed control through mounting bracket, secure with mounting nut.
4. Secure mounting bracket to junction box with (2) screws, provided.
5. Install register cover by centering it over fan housing cover plate. Secure to stud wall with provided white mounting screws.
6. Attach cover plate (not provided) and install control knob onto speed control.
7. Complete fireplace installation by following instructions included with fireplace.

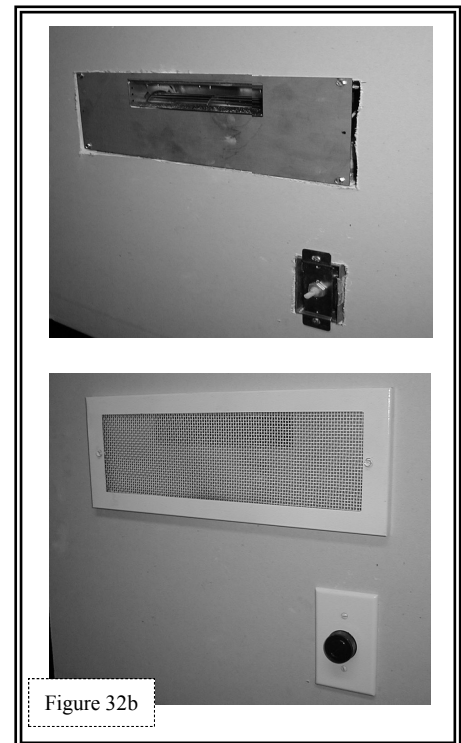

Figure 32b

OPERATING INSTRUCTIONS

1. Upon complete fireplace installation and after the initial burn period, turn fireplace burner ON by following lighting instructions included with fireplace (gas models).
2. Allow fireplace to heat for approximately 15 minutes.
3. Put heat duct fan into operation by turning wall-mounted speed control counter-clockwise until it 'clicks'. The fan should turn on and will be running at its highest speed. Adjust speed to desired air flow level by turning speed control knob counter-clockwise.

MAINTENANCE

The duct register must be kept clear and unobstructed. Clean and vacuum as necessary to remove dust, lint, etc. from fan which will inhibit air flow.

Register cover and fan housing should be removed at least annually to remove dust, lint, etc. from fan. More frequent cleaning may be necessary.

The fireplace must be maintained and serviced as outlined in the unit installation and operating instructions.

LIMITED WARRANTY

KOZY HEAT LIMITED 10 YEAR WARRANTY

This limited 10 Year Warranty will not become effective until the Warranty Registration Form has been completed and mailed to Hussong Manufacturing Co., Inc., P.O. Box 577, Lakefield, MN 56150. This registration form must be received within 30 days of installation. Failure to do so may result in delayed warranty coverage and submission of proof of purchase will be required.

Hussong Manufacturing Co., Inc. warrants to the original purchaser of this Kozy Heat Fireplace, that it is free of defects in materials and workmanship at the time of manufacture.

Subject to the following conditions & requirements, Hussong Manufacturing Co., Inc. extends the following limited warranty under normal use and service, with respect to the Kozy Heat line of gas burning fireplaces.

YEAR 1: Subject to the conditions & requirements listed below, within the first year from date of purchase, Hussong Manufacturing Co., Inc. shall, at its discretion, replace or repair any such defect in material or workmanship, at Hussong Manufacturing Co., Inc.'s expense, including reasonable labor costs to repair or replace the defective component, if a factory pre-authorization is given for the repair.

YEARS 2-10: Subject to the conditions & requirements listed below, beginning with the first day of the second year and continuing through the tenth year, Hussong Manufacturing Co., Inc., will at its discretion, provide repair or replacement parts at current list prices for any defect in material or workmanship of components, including optional components and accessories (if available). Hussong Manufacturing Co., Inc. shall not be responsible for any installation, labor, transportation of other indirect costs.

LIMITATION OF LIABILITY

To make a claim under this warranty, the purchaser must first contact the dealer/installer from whom the fireplace was purchased.

This limited warranty will be void if the fireplace is not installed by a qualified installer and according to the installation instructions. Use of unauthorized components will make this warranty null and void.

This limited warranty also is void if the fireplace is not operated, at all times, according to the operating instructions furnished.

This warranty is limited to defects in material and workmanship. It does not apply to any product that has been subject to negligence, misapplication, improper installation.

No person is authorized to extend the time of this warranty or to accept on Hussong Manufacturing Co., Inc.'s behalf any additional obligation of liability connected with the unit.

It is expressly agreed and understood that this warranty is Hussong Manufacturing Co., Inc.'s sole obligation and purchaser's exclusive remedy for defective fireplace equipment. Hussong Manufacturing Co., Inc. shall not be liable for any consequential, incidental or contingent damages whatsoever. The foregoing warranty is exclusive and in lieu of all other expressed warranties. Hussong Manufacturing Co., Inc. shall not be held to implied warranties or merchantability and fitness for a particular purpose. This warranty replaces all previous warranty policies.

Some states do not allow the exclusion or limitation of incidental or consequential damages or limitations on how long an implied warranty lasts, so the above limitations or exclusions may not apply to you. This warranty gives you specific legal rights and you may also have other rights which vary from state to state.

Hussong Manufacturing Co., Inc. reserves the right to make changes at any time, without notice, in design, material, specifications and prices. Hussong Manufacturing Co., Inc. reserves the right to discontinue models and products.

WARRANTY CONDITIONS & REQUIREMENTS:

1. You are the original purchaser. This warranty is not transferable.
2. Installation of the fireplace is performed by a qualified installer.
3. Installation and operation must comply with installation and operation instructions.
4. Paint and glass gaskets are covered for 30 days from date of purchase.
5. Remote controls and all optional accessories are covered for 1 year from date of purchase.
6. This warranty does not offer coverage for Light Bulbs or Batteries (whether factory, dealer or installer supplied). This includes any damage stemming from either component's nonuse.
7. Components broken, (including glass panels), during shipping, careless handling of components, or defects resulting from improper installation, misuse of the fireplace and components are not covered under this warranty.
8. This warranty does not cover any part of the fireplace or any components which have been exposed to or submerged under water.
9. Hussong Manufacturing Co., Inc. must be notified by the dealer the fireplace was purchased from or a qualified installer/service technician of the defect.
10. Annual service of the fireplace as required in the installation manual, is performed by a qualified installer/service technician. (Copies of such service records may be required to claim a warranty).
11. All previous warranty/service has been performed by a qualified installer or service technician. (Copies of such service records may be required to claim a warranty).

LIFETIME WARRANTY

LIFETIME WARRANTY

THIS LIFETIME WARRANTY COVERAGE WILL BE EXTENDED AS DESCRIBED BELOW PROVIDED ALL WARRANTY CONDITIONS AND REQUIREMENTS ARE MET AS OUTLINED IN THE 10 YEAR LIMITED WARRANTY POLICY.

LIFETIME WARRANTY COVERAGE

LIFETIME WARRANTY IS EXTENDED AS FOLLOWS: Hussong Manufacturing Co., Inc. warranties to the original purchaser that the firebox, heat exchanger, fiber logs, burner tube and glass panel of this Kozy Heat Fireplace will not be defective in material or workmanship under normal use and service for as long as you own this product. If any of these components fail due to defects in material and workmanship under normal use and service, Hussong Manufacturing, Co., Inc. will, at its sole discretion, repair or replace the defective component. This LIFETIME WARRANTY does not cover any installation, labor, transportation or other indirect cost arising from defective components.

LIMITATION OF LIABILITY

This Lifetime Warranty will be void if the fireplace is not installed by a qualified installer and according to the installation instructions. Use of unauthorized components will make this warranty null and void. This Lifetime Warranty also is void if the fireplace is not operated, at all times, according to the operating instructions furnished. This warranty is limited to defects in material and workmanship of components specified. It does not apply to any product that has been subject to negligence, misapplication, improper installation.

No person is authorized to extend the time of this Lifetime Warranty or to accept on Hussong Manufacturing Co., Inc.'s behalf any additional obligation of liability connected with the unit.

Hussong Manufacturing Co., Inc. may fully discharge all obligations with respect to this Lifetime Warranty by refunding the wholesale price of the defective component(s).

It is expressly agreed and understood that this Lifetime Warranty is Hussong Manufacturing Co., Inc.'s sole obligation and original purchaser's exclusive remedy for defective fireplace equipment. Hussong Manufacturing Co., Inc. shall not be liable for any consequential, incidental or contingent damages whatsoever other than those incurred by Hussong Manufacturing Co., Inc. to repair or replace the defective component. The foregoing warranty is exclusive and in lieu of all other expressed warranties. Hussong Manufacturing Co., Inc. shall not be held to implied warranties, including but not limited to the implied warranties of merchantability and fitness for a particular purpose. This lifetime warranty replace all previous lifetime warranty policies.

Hussong Manufacturing Co., Inc. reserves the right to make changes at any time, without notice, in design, material, specifications and prices. Hussong Manufacturing Co., Inc. reserves the right to discontinue models and products.

To activate this Lifetime Warranty coverage, this registration card must be completed and mailed with your completed 10 Year Limited Warranty form within 30 days of installation to the following address:

*Hussong Manufacturing Co., Inc.
P.O. Box 577
204 Industrial Park Drive
Lakefield, MN 56150-0577*

Sept. 2011

CUT ALONG DOTTED LINE

PURCHASER NAME: _____
ADDRESS: _____

TELEPHONE: _____

INSTALLATION DATE: _____
MODEL #: _____
SERIAL #: _____

INSTALLER NAME: _____
ADDRESS: _____

TELEPHONE: _____



Supplemental Installation and Homeowner Information Manual for SLAYTON 42:



SLA-42

DIRECT VENT GAS LINEAR FIREPLACE

English and French Installation Manuals Available Through Your Local Dealer or Visit Our Website at www.kozyheat.com
Les manuels d'installation en anglais et en français sont disponibles chez votre détaillant local ou en visitant notre site Web : www.kozyheat.com

IMPORTANT: This supplemental installation and homeowner manual is to be used in conjunction with SLAYTON 42 INSTALLATION MANUAL. Read both manuals before installing and operating appliance.

INSTALLER: Leave this manual with the appliance.
CONSUMER: Retain this manual for future reference.

WARNING: Improper installation, adjustment, alteration, service or maintenance can cause injury or property damage. Refer to fireplace installation manual and this manual. For assistance or additional information consult a qualified installer, service agency or the gas supplier.

WARNING: If the information in these instructions is not followed exactly, a fire or explosion may result causing property damage, personal injury or loss of life.

—Do not store or use gasoline or other flammable vapors and liquids in the vicinity of this or any other appliance.

WHAT TO DO IF YOU SMELL GAS:

- ❑ Do not try to light any appliance.
 - ❑ Do not touch any electrical switch: do not use any phone in your building.
 - ❑ Immediately call gas supplier from a neighbor's phone. Follow the gas supplier's instructions.
 - ❑ If you cannot reach your gas supplier, call the fire department.
- Installation and service must be performed by a qualified installer, service agency or the gas supplier.



WARNING



**HOT GLASS WILL CAUSE BURNS.
DO NOT TOUCH GLASS UNTIL COOLED.
NEVER ALLOW CHILDREN TO TOUCH GLASS.**



Report No. 216-S-36c-6.5

NOVEMBER 2012
SL42-IPI-SUP-REV-03

TABLE OF CONTENTS

<u>SAFETY INFORMATION</u>	
Safety Information	2
<u>SPECIFICATIONS</u>	
Components List	3
Gas Pressure Requirements / BTU's	3
<u>OPTIONAL FAN KIT INSTALLATION</u>	
Optional Fan Kit Installation	4
<u>WIRING SCHEMATICS</u>	
Wiring Schematics	5
<u>OPERATING INSTRUCTIONS</u>	
Control System Components	6
System Operations	7-10
Lighting and Shutdown	11-12
Pressure Testing	13
<u>TROUBLESHOOTING</u>	
Troubleshooting	14-15
<u>CONVERSION KIT INSTRUCTIONS</u>	
Conversion Kit Instructions	16-17
<u>FINALIZING THE INSTALLATION</u>	
Finalizing the Installation	18
<u>MAINTENANCE</u>	
Maintenance	19
<u>REPLACEMENT PARTS</u>	
Replacement Parts	20

SAFETY INFORMATION

This fireplace has been tested by OMNI-Test Laboratories, Portland, Oregon and complies with:

ANSI Z21.88-2009/CSA 2.33-2009, "Standard for Vented Gas Fireplace Heaters"
CAN/CGA 2.17-M91 (R2009), "Gas-Fired Appliances for Use at High Altitudes"
CAN/CSA P.4.1-09, "Testing Method for Measuring Annual Efficiency"

This installation must conform with local codes, or in the absence of local codes, with the *National Fuel Gas Code, ANSI Z223.1/NFPA 54*, or the *Natural Gas and Propane Installation Code, CSA B149.1*

The appliance, when installed, must be electrically grounded in accordance with local codes or, in the absence of local codes, with the *National Electrical Code, ANSI/NFPA 70*, or the *Canadian Electrical Code, CSA C22.1*.

- Installation and repair should be done only by a qualified service person. The appliance should be inspected by a qualified service person before use. Annual inspection by a qualified service person is required to maintain warranty. More frequent cleaning may be required due to excessive lint from carpeting, bedding materials, etc. It is imperative that control compartments, burners and circulation air passageways of the appliance be kept clean.
- If this appliance is installed directly on carpeting, tile or other combustible material other than wood flooring, the appliance shall be installed on a metal or wood panel extending the full width and depth of the appliance.
- Children and adults should be alerted to the hazards of high surface temperatures and should stay away to avoid burns or clothing ignition.
- Young children should be carefully supervised when they are in the same room as the appliance. Toddlers, young children and others may be susceptible to accidental contact burns. A physical barrier is recommended if there are at risk individuals in the house. To restrict access to a fireplace or stove, install an adjustable safety gate to keep toddlers, young children and other at risk individuals out of the room and away from hot surfaces.
- Clothing or other flammable material should not be placed on or near the appliance.
- Adequate accessibility clearances for servicing and proper operation must be maintained.
- This appliance must not share or be connected to a chimney flue serving any other appliance.
- Keep area around the appliance clear of combustible materials, gasoline and other flammable vapor and liquids.
- The flow of combustion and ventilation air must not be obstructed.
- Due to high temperatures the appliance should be located out of traffic and away from furniture and draperies.
- The glass front or any part removed for servicing the appliance must be replaced prior to operating the appliance. Work should be done by a qualified service technician.
- Clean glass only when cool and only with non-abrasive cleansers.
- **WARNING: DO NOT OPERATE APPLIANCE WITH THE GLASS/FRAME ASSEMBLY REMOVED, CRACKED OR BROKEN. REPLACEMENT OF THE GLASS SHOULD ONLY BE PERFORMED BY A LICENSED OR QUALIFIED SERVICE PERSON.**
- The glass assembly, Part #SL42-057T, shall only be replaced as a complete unit, as supplied by Hussong Mfg. Co., Inc. DO NOT SUBSTITUTE MATERIALS.
- Do not strike or slam glass assembly.
- Any safety screen or guard removed for servicing the appliance must be replaced prior to operating the appliance.
- Under no circumstances should any solid fuel (wood, coal, paper or cardboard etc.) be used in this appliance.
- Keep burner and control compartment clean.
- Do not use this fireplace if any part has been under water. Immediately call a qualified service technician to inspect this appliance and to replace any part of the control system and any gas control which has been under water.

SPECIFICATIONS

COMPONENTS LIST

PART NUMBER	DESCRIPTION
SL42-150	Control Board Assembly
SL42-135	Burner Assembly
SL42-BLK	Light Kit
SL42-057T	Glass Frame Assembly
700-408	Remote Control
600-002	Double Receptacle Assembly
942-085	5" Restrictor Plate
SL42-HHS	Horizontal Vent Heat Shield

	NATURAL GAS	LP GAS
MINIMUM INLET GAS PRESSURE	5" WC (1.25 kPa) (7" WC (1.74 kPa) recommended)	12" WC (2.99 kPa) (recommended)
MAXIMUM INLET GAS PRESSURE	10.5" WC (2.62 kPa)	13" WC (3.24 kPa)
MANIFOLD PRESSURE (HI)	3.8" WC (.95 kPa)	11" WC (2.74 kPa)
MANIFOLD PRESSURE (LO)	1.1" WC (.27 kPa)	2.9" WC (.72 kPa)
ORIFICE SIZE	#31	#47
INPUT BTU/hr. (kW)	42,000 BTU/hr (12.31 kW)	42,000 BTU/hr (12.31 kW)
MINIMUM INPUT BTU/hr. (kW)	21,000 BTU/hr (6.16 kW)	21,000 BTU/hr (6.16 kW)

HIGH ALTITUDE INSTALLATIONS

ATTENTION

In the USA: The appliance may be installed at higher altitudes. Please refer to your American Gas Association guidelines which state: the sea level rated input of Gas Designed Appliances installed at elevations above 2000ft. (610m) is to be reduced 4% for each 1000ft. (305m) above sea level. Refer also to National Fuel Gas Code, ANSI Z223.1/NFPA 54, local authorities, or codes which have jurisdiction in your area regarding the de-rate guidelines.

In Canada: When the appliance is installed at elevations above 4500ft. (1372m), the certified high altitude rating shall be reduced at the rate of 4% for each additional 1000ft. (305m). Refer also to CSA-B149.1 Natural Gas and Propane Installation Code, Local authorities, or codes which have jurisdiction in your area regarding the de-rate guidelines.

OPTIONAL FAN KIT INSTALLATION

INSTALLATION OF THIS FAN SHOULD BE DONE ONLY BY A QUALIFIED INSTALLER

WARNING

MAKE SURE HOUSEHOLD BREAKER IS SHUT OFF PRIOR TO WORKING ON ANY ELECTRICAL LINES.

THIS APPLIANCE IS EQUIPPED WITH A THREE-PRONG (GROUNDING) PLUG FOR PROTECTION AGAINST SHOCK HAZARD AND SHOULD BE PLUGGED DIRECTLY INTO A PROPERLY GROUNDED THREE-PRONG RECEPTACLE. DO NOT CUT OR REMOVE GROUNDING PRONG FROM THIS PLUG.

NOTE

This appliance must be electrically grounded and connected in accordance with local codes, or in the absence of local codes, with the National Electrical Code, ANSI/NFPA 70 Current Edition, or the Canadian Electrical Code CSA C22.1.

1. Glass frame assembly must be removed prior to installing this optional fan kit.
2. Disconnect wiring terminals from fan motors before installing this kit.

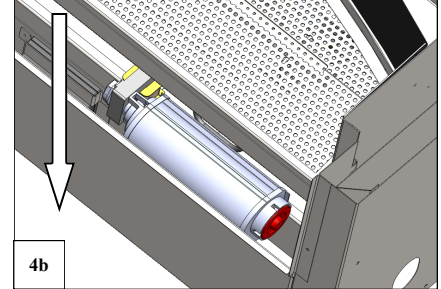
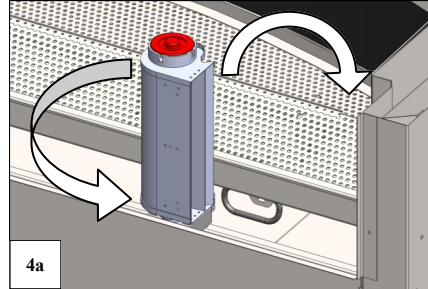
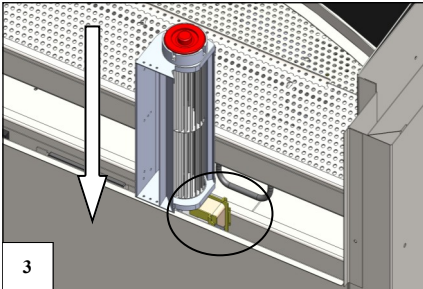

3. With the motor end of right side fan facing down and to the right, insert fan into chamber.
4. When motor end clears fireplace face, turn fan to left. Rotate top end down and to the right, lowering fan into chamber.

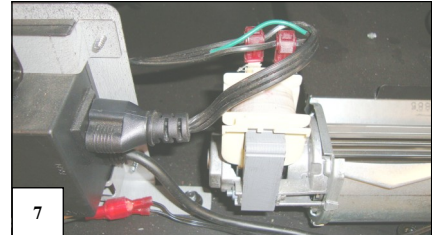
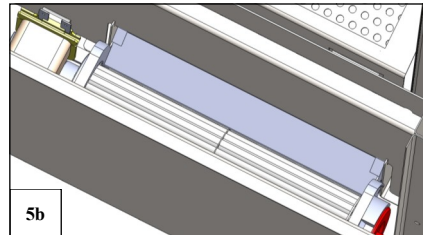
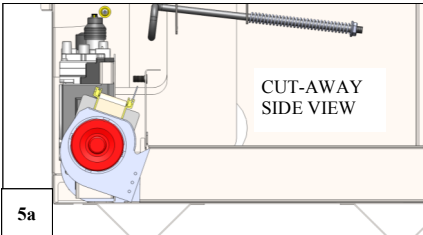

5. Position fan as shown in figure 5a. As you rotate fan towards you, the upper edge of fan discharge will lock behind top edge of fireplace air channel opening, securing fan in place. Do not let fan rest on any electrical cords.
6. Repeat for left fan, noting that fan rotation in steps 3 and 4 will be opposite of right fan.
7. Reattach wiring terminals to fan motors.
8. Plug fan cord into receptacle .
9. Reinstall glass frame assembly.

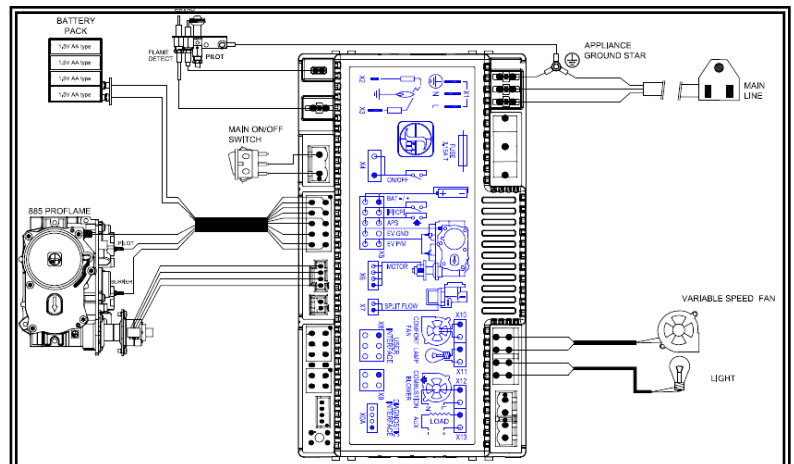

WIRING SCHEMATICS

IMPORTANT

THIS SYSTEM REQUIRES ELECTRICITY (120V) AND / OR BATTERIES TO OPERATE.

USING BATTERY BACK UP WILL OPERATE BURNER ONLY. FAN AND LIGHT COMPONENTS WILL NOT FUNCTION ON BATTERY BACK-UP POWER.

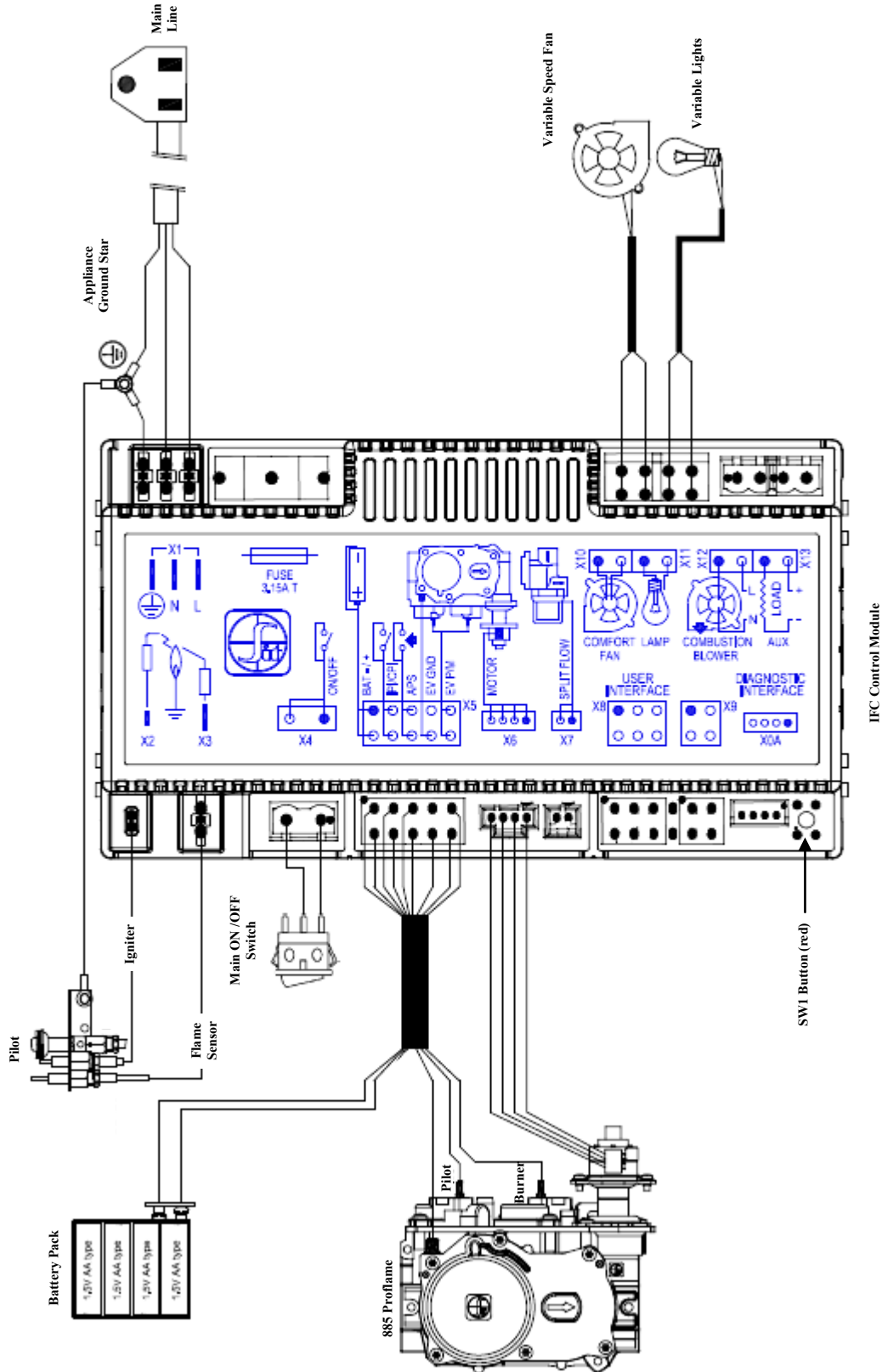
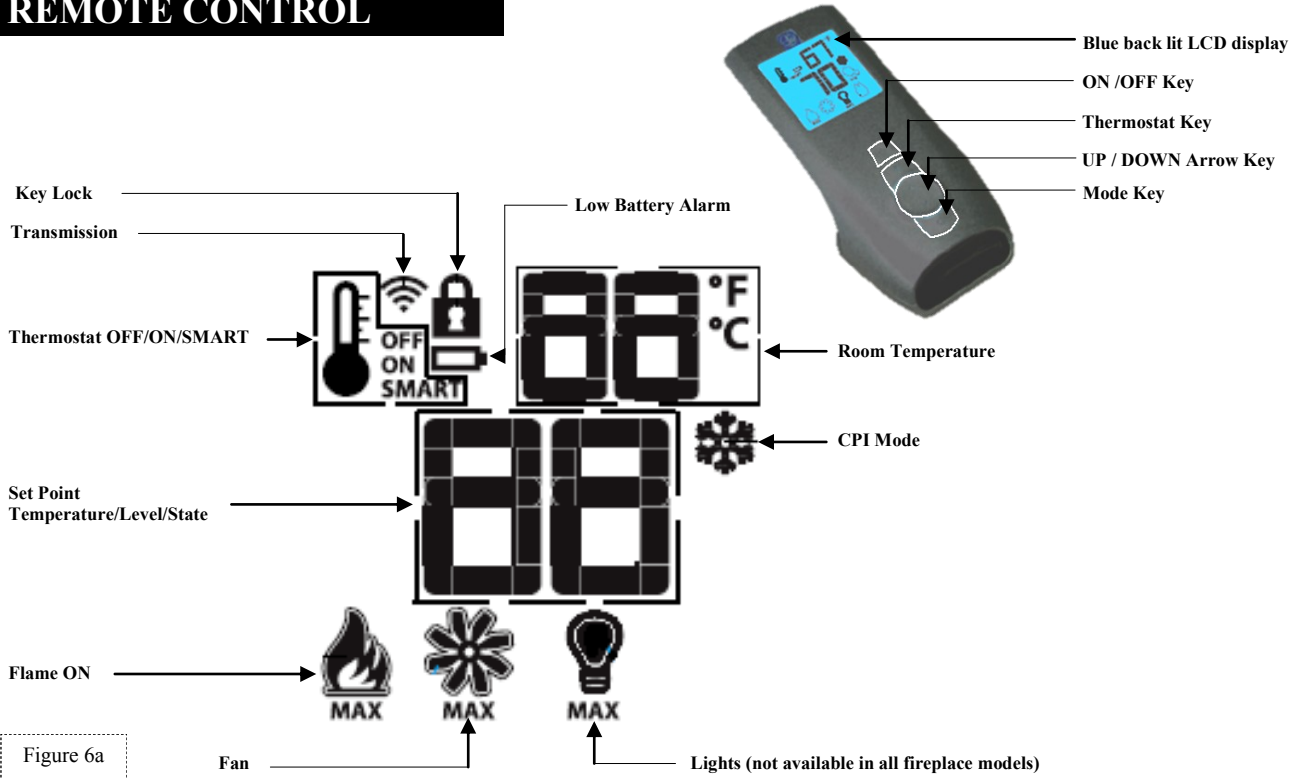

Figure 5a

CONTROL SYSTEM COMPONENTS

REMOTE CONTROL



GAS VALVE

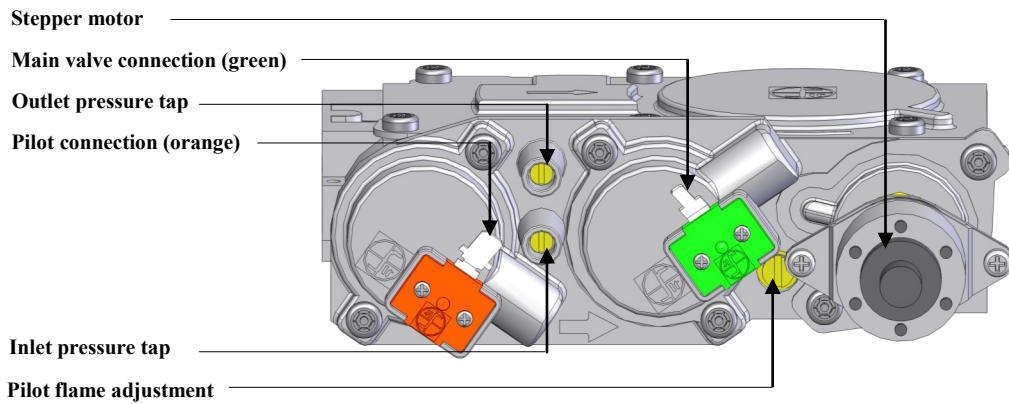

PILOT ASSEMBLY

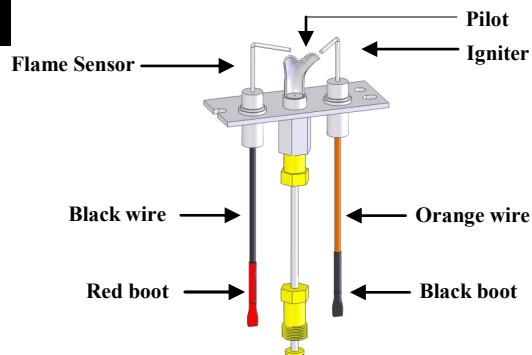

SYSTEM OPERATION

INITIALIZING THE SYSTEM FOR THE FIRST TIME

1. Set ON/OFF rocker switch to OFF position.
2. Install 4 AA batteries (included in components packet) into battery backup holder.
3. Connect IFC Control Module to AC power supply.
4. Install 3 AAA batteries (included in components packet) into remote control battery bay (located on base of remote control).

NOTE: Performing the next step will initiate Pilot Start-up in Manual Mode:
Pilot igniter will spark repeatedly.
Pilot will ignite if gas is supplied to the fireplace.

Remove all packaging / combustible material from fireplace before proceeding.

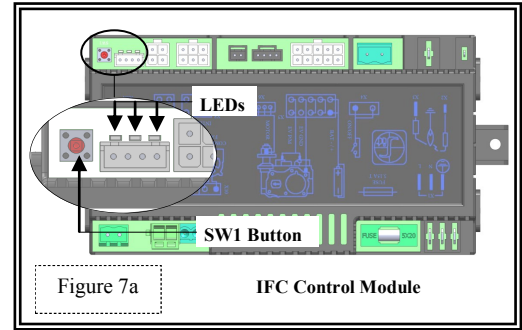

5. Press red SW1 button on IFC control module until module beeps three (3) times and/or an amber LED is illuminated indicating the IFC control module is ready to synchronize with the remote control .
6. Within ten (10) seconds push remote control **ON/OFF** button. The IFC control module will beep (4) times to indicate the remote control's command is accepted and set to the particular code of that remote control. Press remote control **ON/OFF** button again. The pilot will shut down indicating the remote has taken over. The system is now initialized.
7. Setting ON/OFF rocker switch to ON position will allow you to operate fireplace with remote control.

TEMPERATURE DISPLAY

With the system in **OFF** position, press Thermostat Key and Mode Key at the same time to change from degrees F to C. Look at remote control LCD screen to verify that C or F is visible on right side of Room Temperature display.

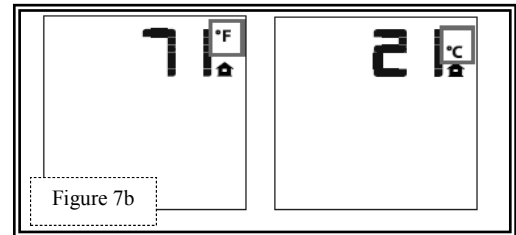

TURN ON THE APPLIANCE

Press **ON/OFF** key on remote control. The display will show all active icons on the screen. A single 'beep' from IFC Control Module will Confirm reception of the command.

TURN OFF THE APPLIANCE

Press **ON/OFF** key on remote control. The display will show only room temperature and icon on the screen. A single 'beep' from IFC control module will confirm reception of the command.

MANUALLY CONTROL FLAME WITH REMOTE CONTROL

The remote control has six (6) flame levels. With system ON and flame level at maximum, press Down Arrow Key once to reduce flame height by one step until flame is turned off. The Up Arrow Key will increase flame height on step each time it is pressed. If Up Arrow Key is pressed while system is on but flame is off, the flame will come on in High position. A single 'beep' will confirm reception of the command. When SMART Thermostat is activated, manual flame height adjustment is disabled.

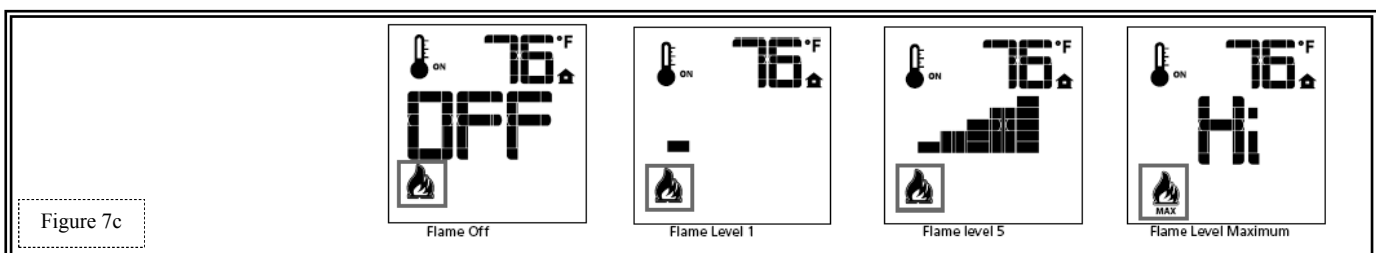

SYSTEM OPERATION

ROOM THERMOSTAT (Remote Control Operation)

The remote control can operate as a room thermostat. The thermostat can be set to desired temperature to control a rooms comfort level.

To activate this function, press the Thermostat Key. The LCD display will change to show the room thermostat is ON and set temperature is now displayed. To adjust set temperature, press Up or Down arrow keys until desired set temperature is display on LCD screen.

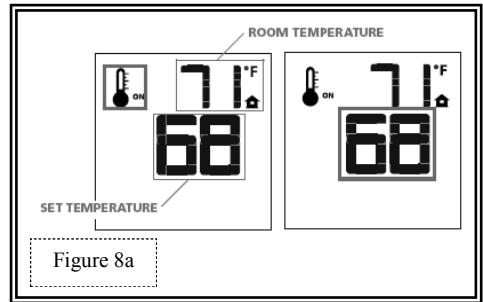

SMART THERMOSTAT (Remote Control Operation)

The Smart Thermostat function adjusts flame height based on set temperature and actual room temperature. As room temperature gets closer to set point the Smart Function will automatically adjust flame down.

1. Press Thermostat key until word SMART appears on right side of temperature bulb graphic.
2. To adjust set temperature, press Up/Down arrow keys until desired set temperature is displayed on LCD screen.

When SMART Thermostat is activated, manual flame height adjustment is disabled.

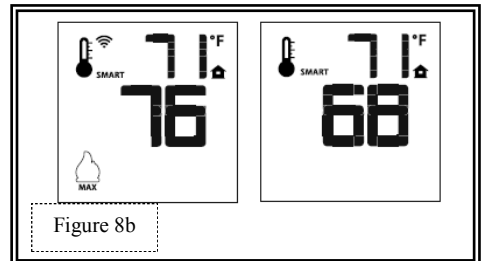

FAN SPEED CONTROL

Fan speed can be adjusted through six (6) speeds. To activate this function use Mode Key to index to fan control icon. Use Up/Down Arrow Keys to turn on, off or adjust fan speed. A single 'beep' will confirm reception of the command.

In Thermostat Mode: Fan(s) have a five (5) minute delay time when fireplace is lit, allowing time for heat to build in fireplace before operating, and will continue operating for approximately twelve (12) minutes after fireplace has been turned off.

In Manual Mode: Fan (s) will operate at previous setting. There is no delay in start up or stop time.

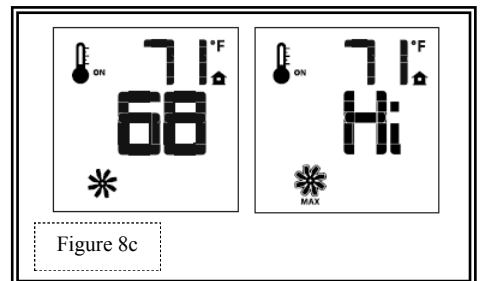

ACCENT LIGHT KIT (not available in all fireplace models)

1. Use MODE key to guide you to LIGHT icon.
2. The light intensity can be adjusted through six (6) levels. Use UP/DOWN Arrow Keys to adjust intensity level. A single beep will confirm reception of the command.

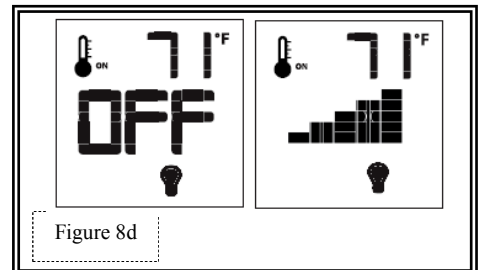

KEY LOCK

This function locks the keys to avoid unsupervised operation.
To Activate: Press MODE and UP keys at same time.
To De-activate: Press MODE and UP keys at same time.

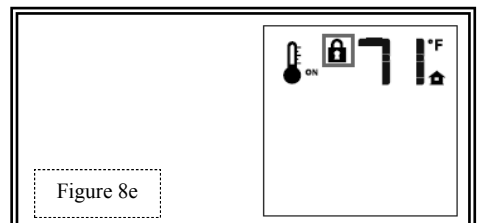

SYSTEM OPERATION

LOW BATTERY DETECTION

REMOTE CONTROL: Remote control battery lifespan depends on various factors including battery quality, number of ignitions, changes to room thermostat set point, etc. When remote control batteries are low, a Battery Icon will appear on the LCD display before all battery power is lost. When batteries are replaced this icon will disappear.

BACKUP BATTERY PACK (used when electrical power is interrupted): Backup batteries lifespan depends on various factors including battery quality, number of ignitions, changes to room thermostat set point, etc. When backup batteries are low, a double-beep will be emitted from the IFC control module when it receives an ON/OFF command from the remote control. This is an alert for a low battery condition of the backup batteries and after this double-beep warning, no commands will be accepted until batteries are replaced. When batteries are replaced a beep will be emitted from IFC control module as soon as powered.

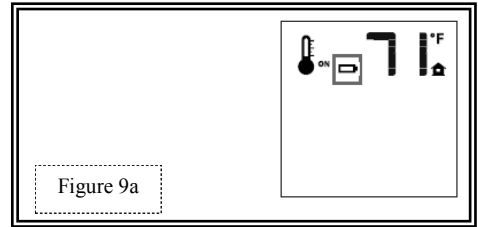

CONTINUOUS PILOT / INTERMITTENT PILOT (CPI/IPI)

This system has the option of a continuous (standing) pilot feature. This allows you to change from a spark-to-pilot system to a standing pilot system during cold weather conditions. By having the pilot on continuously, the firebox will remain warm and a draft is established in the vent, allowing the main burner to turn on with less air-flow disruption.

With system in OFF position, press Mode Key to index to CPI mode icon. Pressing the UP Arrow Key will activate the Continuous Pilot Ignition Mode (CPI). Pressing the Down Arrow Key will return to IPI. A single beep will confirm the reception of the command.

A snowflake icon will be visible during setup of either IPI or CPI modes. In IPI mode the snowflake is not visible on LCD screen. In CPI mode the snowflake will remain visible on LCD screen.

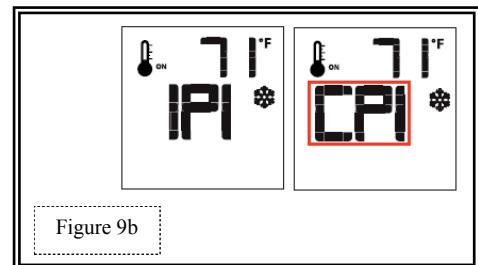

RESETTING SYSTEM FOR MANUAL OPERATION

1. Put ON/OFF switch in OFF position.
2. Press red SW1 button on IFC control module until the IFC control module emits three (3) beeps and an amber LED is illuminated, indicating the IFC control module is ready to synchronize with remote control. Within ten (10) seconds press the red SW1 button on IFC control module again. The pilot will automatically light.
3. Turn main burner on by pressing ON/OFF switch to ON position, turn off by pressing ON/OFF switch to OFF position. Pilot will remain lit even if burner is turned off.

When operating fireplace in this capacity, the only function available is burner operation on HI.

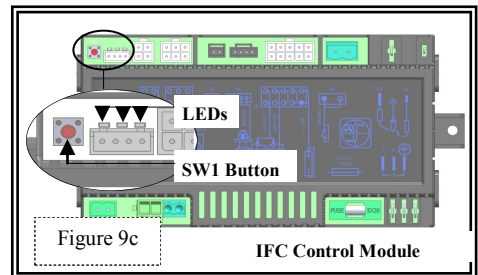

AUTOMATIC SAFETY RESTART

This system will execute an automatic turn OFF command within (24) hours of a continued pilot flame ignition. This allows the system to verify correct safety functions. After turn OFF sequence is completed, the IFC control module will re-execute the latest command.

SYSTEM OPERATION

S.I.T. PROFLAME 2 IFC IGNITION AND RESET INFORMATION

IGNITION SEQUENCE

Starting from OFF, press remote control ON button. Approximately (4) seconds after ON/OFF button is pushed, the IFC control module will start the spark. First ignition try will last approximately (60) seconds.

If there is no flame ignition (rectification) during the first try for ignition, the IFC control module will stop sparking for approximately (35) seconds. After this wait time, the IFC control module will start the second try for ignition by sparking for approximately (60) seconds. If ignition is successful on third ignition attempt, there will be a (60) second delay before the main burner lights.

If after this third attempt there is still no positive ignition, the IFC control module will go into LOCK OUT and the red LED will blink (3) times in intervals until the system is reset.

LED Indicator Location: Corner of IFC control module. (IFC control module location determined by fireplace model and design. May be located in component housing behind lower grill, or behind left side access panel).

LOCK OUT = LED blinks (3) times in intervals until the system is reset.

In Summary:

1. The IFC control module will try (2) times for ignition.
2. Each try for ignition will last approximately (60) seconds.
3. The wait time between the two tries is approximately (35) seconds.

RESET IFC CONTROL MODULE WHEN SYSTEM GOES INTO LOCK OUT

Reset Using ON/OFF Switch:

Set ON/OFF switch to OFF position. Wait approximately (2) seconds and move switch to the ON position. The ignition sequence will start again.

Reset Using Remote Control ON/OFF Button:

Turn the system off by pressing the remote control ON/OFF button. After approximately (2) seconds press the remote control ON/OFF button again. The IFC control module will reset and the ignition sequence will start again.

Reset By Cycling Flame:

In the Manual Flame Control Mode, use the Down Arrow Button to reduce flame to off (indicated by OFF displayed on Remote Control Display Screen). Wait approximately (2) seconds and press the Up Arrow Button, the ignition sequence will start.

ADDITIONAL DIAGNOSTIC INDICATIONS INFORMATION

Low Battery Condition (<4V) Remote Control: Battery Icon will appear on LCD remote control display. Replace batteries.

Low Battery Condition (<4V) Battery Backup: Red LED Indicator will blink (1) time in intervals. Low double-beep emitted from IFC control module when it receives an ON/OFF command from the remote control. Replace Batteries.

Pilot Flame Error Condition: Red LED Indicator will blink (2) times in intervals. Contact your dealer if this occurs.

System Lock Out Condition: Red LED Indicator will blink (3) times in intervals. Make sure gas is turned on. Make sure sensor is not shorted. Follow **Reset IFC Control Module When System Goes Into Lock Out** instructions above.

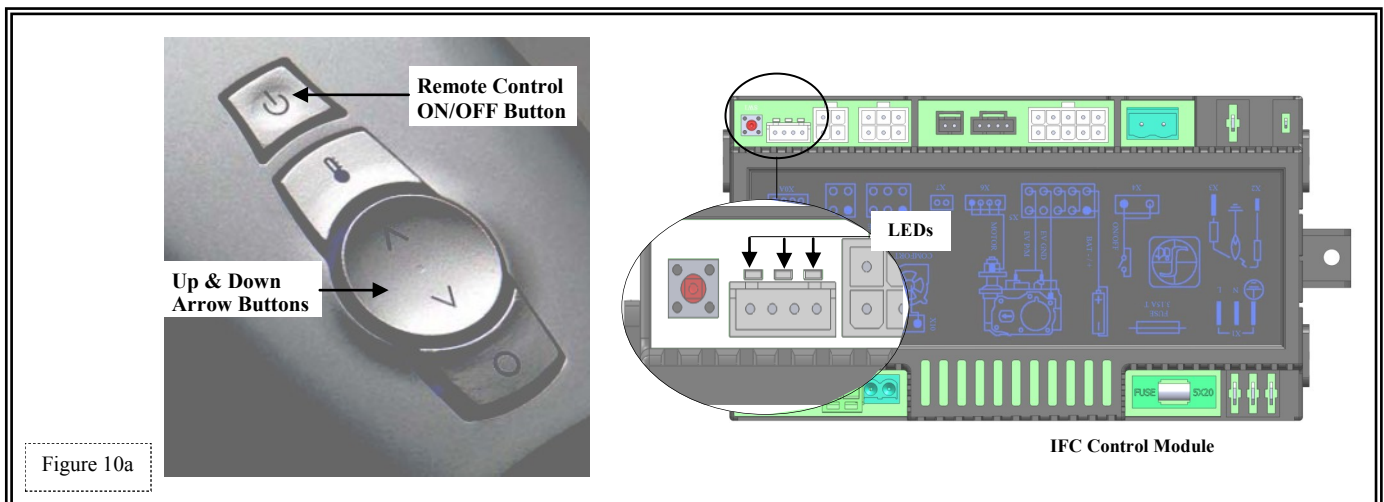

LIGHTING AND SHUTDOWN

FOR YOUR SAFETY - READ BEFORE OPERATING

WARNING

IF YOU DO **NOT** FOLLOW THESE INSTRUCTIONS EXACTLY, A FIRE OR EXPLOSION MAY RESULT, CAUSING PROPERTY DAMAGE, PERSONAL INJURY OR LOSS OF LIFE.

1. This appliance is equipped with an ignition device which automatically lights the pilot. **DO NOT** try to light the pilot by hand.
2. BEFORE OPERATING, smell all around the appliance area for gas. Be sure to smell next to the floor because some gas is heavier than air and will settle on the floor.

WHAT TO DO IF YOU SMELL GAS:

- * Do not try to light any appliance.
 - * Do not touch any electrical switch; do not use any phone in your building.
 - * Immediately call your gas supplier from a neighbor's phone. Follow the gas supplier's instructions.
 - * If you cannot reach your gas supplier, call the fire department.
3. Do not use this appliance if any part has been under water. Immediately call a qualified service technician to inspect the appliance and to replace any part of the control system and any gas control which has been under water.

WARNING

CHILDREN AND ADULTS SHOULD BE ALERTED TO THE HAZARDS OF HIGH SURFACE TEMPERATURES AND SHOULD STAY AWAY TO AVOID BURNS OR CLOTHING IGNITION. YOUNG CHILDREN SHOULD BE CAREFULLY SUPERVISED WHEN THEY ARE IN THE SAME ROOM AS THE APPLIANCE.

CLOTHING OR OTHER FLAMMABLE MATERIAL MUST NOT BE PLACED ON OR NEAR THE APPLIANCE.

DO NOT STORE OR USE GASOLINE OR OTHER FLAMMABLE VAPORS AND LIQUIDS IN THE VICINITY OF THIS OR ANY OTHER APPLIANCE.

NOTE

A PAINT SMELL WILL OCCUR DURING THE FIRST FEW HOURS OF BURNING. IT IS RECOMMENDED TO LEAVE THE FAN OFF DURING THIS PERIOD TO HELP SPEED THE PAINT CURING PROCESS.

THIS FIREPLACE MAY PRODUCE NOISES OF VARYING DEGREE AS IT HEATS AND COOLS DUE TO METAL EXPANSION AND CONTRACTION. THIS IS NORMAL AND DOES NOT AFFECT THE PERFORMANCE OR LONGEVITY OF THE FIREPLACE.

DUE TO HIGH SURFACE TEMPERATURES, KEEP CHILDREN, CLOTHING AND FURNITURE AWAY.

This appliance needs fresh air for safe operation and must be installed so there are provisions for adequate combustion and ventilation air.

LIGHTING AND SHUTDOWN (cont.)

OPERATING INSTRUCTIONS

STOP!

Read safety information on previous page and front cover of this manual before continuing.

1. Turn off all electric power to the appliance.

ATTENTION

This appliance is equipped with an ignition device which automatically lights the pilot. **DO NOT** try to light the pilot by hand.

2. Press hand held remote **OFF** button.
3. Wait five (5) minutes to clear out any gas. Then smell for gas, including near the floor. If you smell gas, **STOP!** Follow 'WHAT TO DO IF YOU SMELL GAS' below. If you don't smell gas, go to next step.

WHAT TO DO IF YOU SMELL GAS:

- * Do not try to light any appliance.
- * Do not touch any electric switch; do not use any phone in your building.
- * Immediately call your gas supplier from a neighbor's phone. Follow the gas supplier's instructions.
- * If you cannot reach your gas supplier, call the fire department.

4. Turn ON all electric power to the appliance.
5. Press hand held remote **ON** button.

CAUTION

If fireplace will not operate, follow instructions **TO TURN GAS OFF TO APPLIANCE** and call your service technician or the gas supplier.

NOTE

When fireplace is initially lit, condensation will appear on the glass; this is normal in all gas fireplaces and will disappear after several minutes.

TO TURN GAS OFF TO APPLIANCE

1. Press hand held remote **OFF** button.
2. Turn OFF all electric power to appliance if service is to be performed.
3. Manual shut-off valve located behind lower grill. Turn manual shut-off valve to **OFF**.

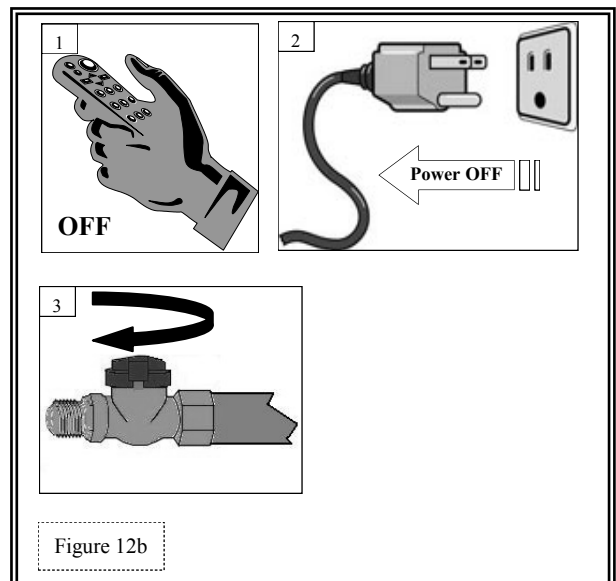
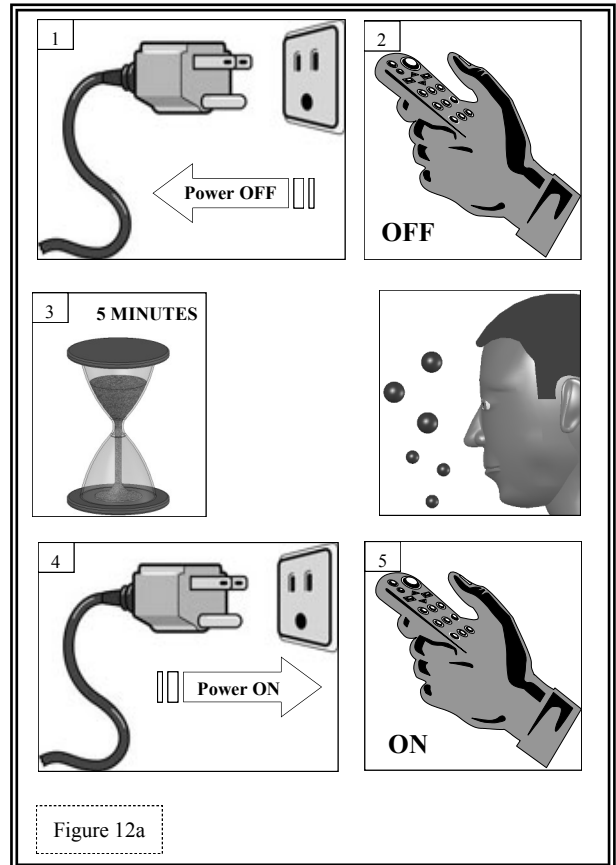

PRESSURE TESTING

IMPORTANT

Pressure check taps for manifold (outgoing) and inlet (incoming) pressure have been incorporated into the valve. The pressure tap marked OUT measures outgoing pressure and the pressure tap marked IN measures incoming pressure. Follow instructions below for proper testing procedures. Refer to page 17 for proper NAT and LP manifold pressures.

NOTE

The appliance and its appliance main gas valve must be disconnected from the gas supply piping system during any pressure testing of that system at test pressures in excess of 1/2 psi (3.5 kPa). The appliance must be isolated from the gas supply piping system by closing its equipment shutoff valve during any pressure testing of the gas supply piping system at test pressures equal to or less than 1/2 psi (3.5 kPa).

INLET PRESSURE TEST:

1. Loosen inlet (IN) pressure tap screw (counter-clockwise).
2. Attach manometer using a 1/4" I.D. hose.
3. Light pilot and burner. Check pressure to ensure it is between the min. and max. recommended pressure settings.
4. Turn off burner and pilot.
5. Disconnect hose and tighten screw (clockwise). Screw should be snug, do not over tighten.
6. Relight pilot and burner. Reattach manometer to inlet pressure tap to verify that it is completely sealed. Manometer should read no pressure.

NOTE

If inlet pressure reading is too high or too low, contact the gas company. Only a qualified gas service technician should adjust incoming gas pressure.

CAUTION

A LOW PRESSURE READING CAN CAUSE DELAYED IGNITION.

MANIFOLD PRESSURE TEST:

1. Light pilot.
2. Loosen manifold (OUT) pressure tap screw (counter-clockwise).
3. Attach manometer to pressure tap using a 1/4" I.D. hose.
4. Light pilot and burner. Check manometer reading.
5. Turn burner and pilot off.
6. Disconnect manometer hose and tighten screw (clockwise). Screw should be snug, do not over tighten.
7. Attach manometer to manifold pressure tap to verify it is completely sealed. Manometer should read no pressure when pilot and burner are on.

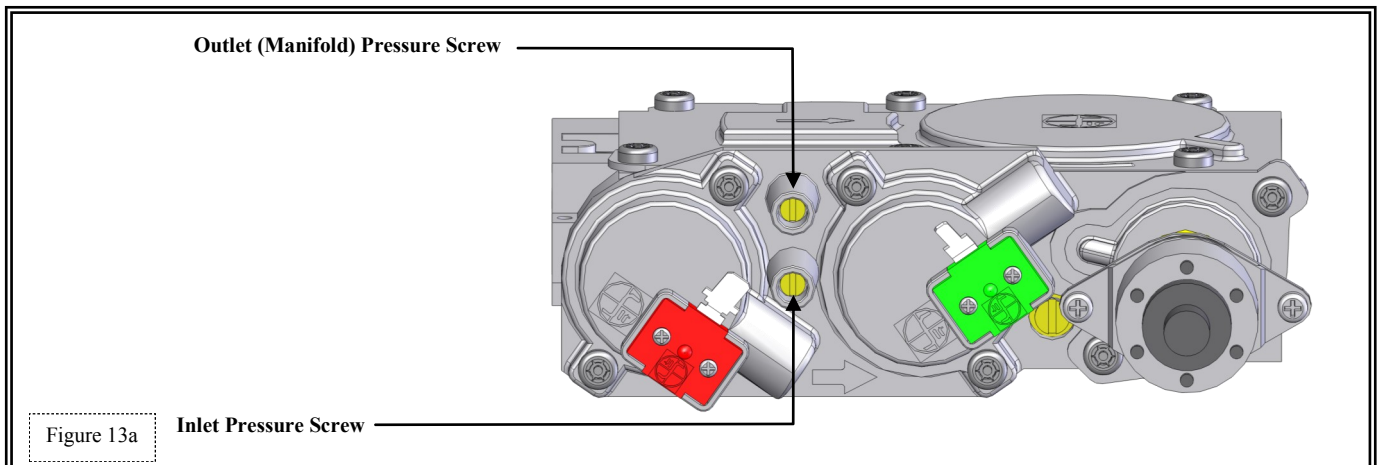

TROUBLESHOOTING

ATTENTION

TROUBLESHOOTING MUST BE PERFORMED BY A QUALIFIED TECHNICIAN.

Before proceeding with the steps in the following troubleshooting guide, verify the power supply is present and receiver batteries and/or battery pack are fresh and installed with correct polarity.

Make sure all connections between wire harnesses and system components are proper and positive.

Make sure communication link between remote control and IFC control module is established.

Verify inlet pressure meets the recommended inlet pressure. If necessary adjust line pressure regulator.

PILOT WILL NOT LIGHT / STAY LIT

- Electrical power interrupted or disconnected. Restore electrical power to fireplace or use battery back-up. Ensure batteries are fully charged if using battery back-up as power source.
- Verify gas supply is turned on. Check remote shut-off valves from fireplace. Usually there is a valve near the main. There may be more than (1) valve between the fireplace and the main.
- Low gas pressure. Low gas pressure can be caused by several situations such as a bent line, too narrow diameter pipe, or low line pressure. Consult with plumber or gas supplier.
- No LP in tank. Check LP (propane) tank. Refill if necessary.
- Wiring disconnection. Use wiring schematic in this manual to determine that all wiring connections are secure and correct.
- Pilot flame not making contact with flame rectification sensor on pilot assembly. This valve is equipped with a pilot flame adjustment screw. Adjust as necessary.
- Pilot adjustment screw not sealed. Seal pilot adjustment screw. Do not over tighten.

PILOT FLAME ALWAYS ON / WILL NOT EXTINGUISH

- System set to CPI mode. Set system to IPI mode.

MAIN FLAME WILL NOT LIGHT

- ON/OFF rocker switch in OFF position. Switch to ON position.
- Remote not working properly. Replace batteries.
- Remote set to thermostat mode and there is no call for heat. Adjust heat setting.
- Thermostat disconnected or set too high. Set thermostat to lower temperature setting.
- Ensure pilot flame will ignite. If not, see pilot flame troubleshooting above.
- Ensure pilot flame is properly located to ignite main flame.
- Plugged main burner orifice.
- Wiring disconnection / improper wiring. Check for faulty or incorrect wiring.
- Verify gas supply is turned on.
- Low gas pressure. Low gas pressure can be caused by several situations such as a bent line, too narrow diameter pipe, or low line pressure. Consult with plumber or gas supplier.

TROUBLESHOOTING

PILOT AND BURNER EXTINGUISH WHILE IN OPERATION

- No LP in tank. Check and refill if necessary.
- Glass frame assembly not installed correctly. Refer to corresponding instructions in this manual.
- Improper vent cap installation. Adjust if necessary.
- Vent cap blockage. Remove debris if necessary.
- Improper pitch on horizontal vent. 1/4" (6mm) rise per foot is required on horizontal venting.
- Inner vent pipe leaking exhaust gases back into firebox. Check for leaks and repair if necessary.
- Excessive draft.

GLASS SOOTING

- Improper glass media placement. Refer to corresponding pages in this installation manual.
- Improper venturi setting. Venturi may need to be opened slightly to allow more air into the gas mix.
- Improper pitch on horizontal venting. 1/4" (6mm) rise per foot required on horizontal venting.

FLAME BURNS BLUE AND LIFTS OFF BURNER

- Improper venturi setting. Venturi may need to be closed slightly.
- Improper vent cap installation. Check for proper vent cap installation.
- Blockage or vent system leaks.

NO REACTION TO COMMAND

- Backup battery pack batteries or remote control batteries low. Replace batteries.
- No communication between remote control and IFC control module. Reprogram remote control to IFC control module. Follow INITIALIZING THE SYSTEM FOR THE FIRST TIME as outlined in this manual.
- A maximum number of failed ignitions or flame restorations have been reached. Reset IFC control module.

Reset Using ON/OFF Switch:

Set ON/OFF switch to OFF position. Wait approximately (2) seconds and move switch to the ON position. The ignition sequence will start again.

Reset Using Remote Control ON/OFF Button:

Turn the system off by pressing the Remote Control ON/OFF button. After approximately (2) seconds press the Remote Control ON/OFF button again. The IFC control module will reset and the ignition sequence will start again.

Reset By Cycling Flame:

In the Manual Flame Control Mode, use the Down Arrow Button to reduce flame to off (indicated by OFF displayed on Remote Control Display Screen). Wait approximately (2) seconds and press the Up Arrow Button, the ignition sequence will start.

CONVERSION KIT INSTRUCTIONS

#NCK-SL42-SP NAT GAS CONVERSION KIT / #LCK-SL42-SP LP GAS CONVERSION KIT

WARNING

This conversion kit shall be installed by a qualified service agency in accordance with the manufacturers instructions and all applicable codes and requirements of the authority having jurisdiction. If the information in these instructions is not followed exactly, a fire, explosion or productions of carbon monoxide may result, causing property damage, personal injury or loss of life. The qualified service agency is responsible for proper installation of this kit. The installation is not proper and complete until operation of the converted appliance is checked as specified in the manufacturer's instructions supplied with the kit. Refer to appliance owner's manual or product data plate for proper inlet and manifold pressure adjustments and orifice sizing.

IMPORTANT

THE CONVERSION SHALL BE CARRIED OUT BY A MANUFACTURER'S AUTHORIZED REPRESENTATIVE, IN ACCORDANCE WITH THE REQUIREMENTS OF THE MANUFACTURER, PROVINCIAL OR TERRITORIAL AUTHORITIES HAVING JURISDICTION AND IN ACCORDANCE WITH THE REQUIREMENTS OF THE CAN/CGA-B149.1 OR CAN/CGA-B149.2 INSTALLATION CODES.

Kit includes: (1) Gas Conversion Label (1) Pilot Injector NAT #.023N / LP #.014LP (1) Gas Label
(1) Burner Orifice: NAT #31 / LP #47 (1) Step Motor Pressure Regulator

CAUTION

THE GAS SUPPLY SHALL BE SHUT OFF PRIOR TO DISCONNECTING THE ELECTRICAL POWER, BEFORE PROCEEDING WITH THE CONVERSION.

WARNING

SHUT OFF GAS SUPPLY AND ELECTRIC POWER TO FIREPLACE.
SHUT OFF GAS SUPPLY BEFORE DISCONNECTING ELECTRIC POWER.

IMPORTANT

For high altitude installations: Above 2000ft. (610m) US / 4500ft. (1372m) Canada, consult the local gas distributor or authority having jurisdiction for proper de-rating methods.

PREPARE THE FIREPLACE:

Remove glass frame assembly, glass media, burner cover and burner venturi housing.

REPLACE BURNER ORIFICE:

1. Remove burner tube.
2. Remove existing orifice cap. Replace with orifice cap included with kit, making sure to tighten cap securely. (Number stamped on orifice)
NAT. GAS: #31 orifice
L.P. GAS: #47 orifice

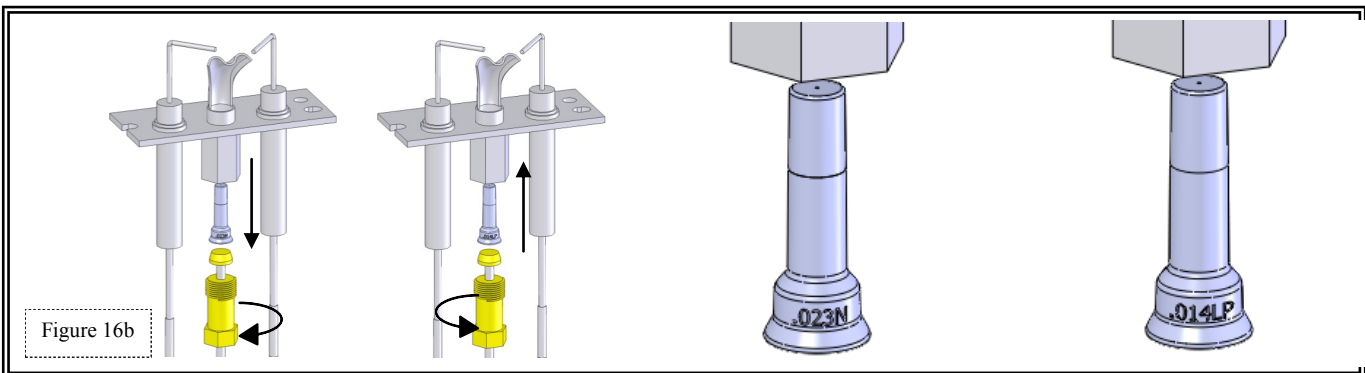
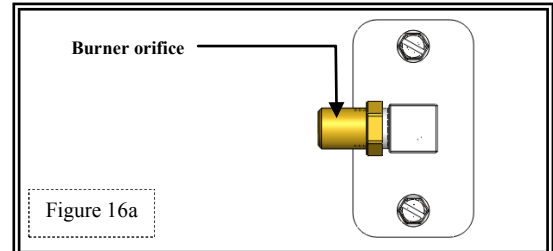

CONVERT PILOT ASSEMBLY:

1. Using a 7/16 wrench, loosen pilot nut by turning counter-clockwise. Remove existing pilot orifice.
2. Install pilot orifice included with kit. (Numbers are stamped on pilot orifices)
NAT: .023N / LP: .014LP
3. Reattach pilot nut and tighten using 7/16 wrench. Fitting should be snug; DO NOT OVER-TIGHTEN!

CONVERSION KIT INSTRUCTIONS

CONVERT THE GAS CONTROL VALVE:

Follow stepper motor pressure regulator instruction sheet included with conversion kit to convert gas valve. (LP or NAT marked on stepper motor pressure regulator).

COMPLETE THE CONVERSION:

- Adjust burner tube venturi to correct setting by loosening screws adjusting cap and retightening screw.
CORRECT SETTINGS: NAT: 1/8" (3mm) open / LP: 5/8" (16mm) open
- Re-install burner tube into fireplace, making sure orifice is properly seated inside burner venturi, and tube is seated into mounting cradles. Re-install burner venturi housing.
- Re-install burner cover, aligning mounting holes with corresponding holes in mounting cradles. Secure with (10) screws previously removed.
- Re-install glass media, being careful not to block pilot.
- Turn on gas and electrical supplies, following lighting and shutdown instructions as outlined on pages 11-12. Check for leaks at all connections with soapy water, whether field or factory made.
- Test inlet pressure, referring to page 13 for proper testing procedures. Chart below states proper pressure readings.
- Visually check pilot flame. Flame should envelope top of flame sensor and extend onto burner far enough for proper ignition. To Adjust pilot: Turn pilot adjustment screw clockwise to decrease or counter-clockwise to increase pilot flame.
- Turn fireplace off.
- Affix gas type sticker to label.
- Re-install glass frame.
- Verify proper ignition and operation of fireplace. Refer to page 18 for proper pilot and burner flame appearance and adjustment.
- Complete and affix 'Gas Conversion' label as close to rating plate as possible.

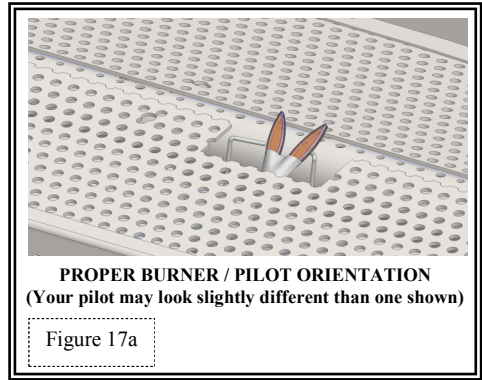

Fireplace Model No.: _____
 This appliance and control was converted on _____ to _____ gas with Kit No.: _____ by _____
 Company: _____
 Address: _____
 Which accepts responsibility that this conversion has been properly made.
 Minimum / Maximum inlet pressures: Refer to rating plate
 Manifold Pressure: Refer to rating plate.
 Orifice size: _____ Input Rating: _____ BTU
 Complete and affix as close as possible to rating plate.

GAS CONVERSION LABEL
(included with conversion kit)

Figure 17b

	<u>NATURAL GAS</u>	<u>LP GAS</u>
MINIMUM INLET GAS PRESSURE	5" WC (1.25 kPa) (7" WC (1.74 kPa) recommended)	12" WC (2.99 kPa) (recommended)
MAXIMUM INLET GAS PRESSURE	10.5" WC (2.62 kPa)	13" WC (3.24 kPa)
MANIFOLD PRESSURE (HI)	3.8" WC (.95 kPa)	11" WC (2.74 kPa)
MANIFOLD PRESSURE (LO)	1.1" WC (.27 kPa)	2.9" WC (.72 kPa)

FINALIZING THE INSTALLATION

FLAME APPEARANCE:

Flame appearance is affected by several factors including altitude, venting configuration and fuel quality. Although the venturi setting has been factory set, adjustments may be necessary for optimal performance and visual aesthetics.

When fireplace is first lit, the flames will be blue. Flames will gradually turn yellowish-orange during first 15 minutes of operation. If flames remain blue, or become dark orange with evidence of sooting (black tips), the burner tube venturi may need adjustment.

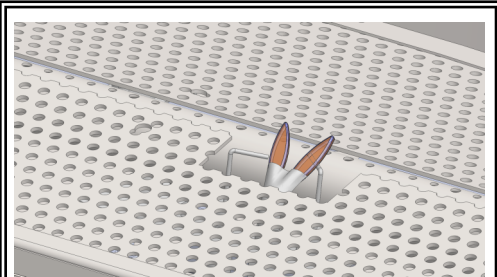

Correct pilot flame

Figure 18a

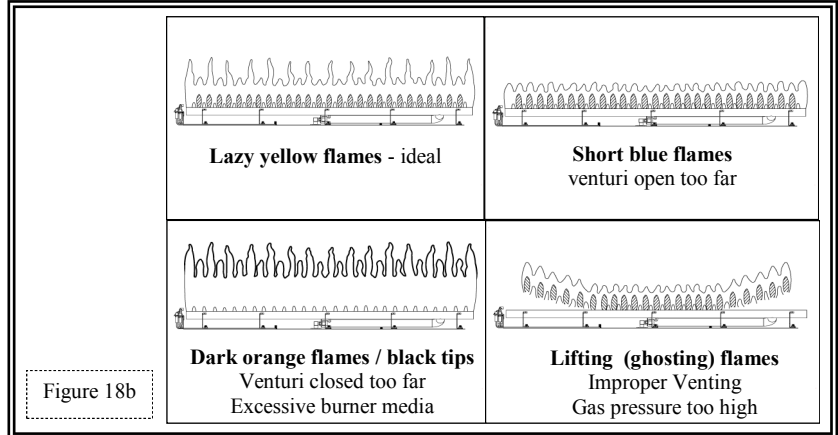

Figure 18b

WARNING

Burner tube adjustable venturi positioning should only be performed by a qualified professional service technician.

FACTORY SET BURNER TUBE VENTURI SETTINGS (ADJUST AS NECESSARY FOR YOUR INSTALLATION)

NATURAL GAS	LP (PROPANE) GAS
1/8" (3mm) OPEN	5/8" (16mm) OPEN

BURNER TUBE VENTURI ADJUSTMENT GUIDELINES

VENTURI POSITION	FLAME COLOR	VENTURI ADJUSTMENT
Closed too far	Dark orange flame with black tips	Open venturi setting slightly
Open too far	Blue flames	Close venturi setting slightly

IMPORTANT

SLIGHT ADJUSTMENTS TO BURNER VENTURI OPENING CREATE DRAMATIC RESULTS. ADJUST AT SLIGHT INCREMENTS UNTIL DESIRED LOOK IS ACHIEVED. ALWAYS BURN FIREPLACE FOR AT LEAST 15 MINUTES AND ALLOW TIME TO COOL BEFORE MAKING ANY FURTHER ADJUSTMENTS.

TO ADJUST VENTURIS:

WARNING

To avoid property damage or personal injury, allow fireplace ample time to cool before making any adjustments.

1. Remove glass frame assembly, glass media, burner venturi housing, burner cover and burner from fireplace.
2. Loosen burner venturi screw, make adjustment, retighten screw.
3. Re-install burner, making sure venturi is positioned over burner orifice. Re-install burner venturi housing.
4. Reinstall burner cover, glass media, and glass frame assembly.
5. Light fireplace. Wait at least 15 minutes before determining if any further adjustments are necessary.

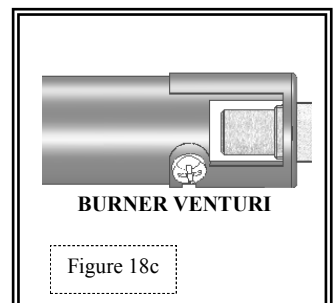

Figure 18c

MAINTENANCE

The appliance is required to be inspected at least once a year by a professional service person.

The compartment below firebox must be cleaned at least once a year, more frequent cleaning may be required due to excessive lint from carpeting, bedding materials, or other fibrous materials. Use a vacuum to clean all components at least once a year.

NOTE

INSTALLATION AND REPAIR SHOULD BE DONE ONLY BY QUALIFIED SERVICE PERSON. THE APPLIANCE SHOULD BE INSPECTED BEFORE USE AND AT LEAST ANNUALLY BY A PROFESSIONAL SERVICE PERSON. MORE FREQUENT CLEANING MAY BE REQUIRED DUE TO EXCESSIVE LINT FROM CARPETING, BEDDING MATERIAL, ETC. IT IS IMPERATIVE THAT CONTROL COMPARTMENTS, BURNERS AND CIRCULATING AIR PASSAGEWAYS OF THE APPLIANCE BE KEPT CLEAN.

CONTROL BOARD SYSTEM

- Annual cleaning of burner system is required. Vacuum all components thoroughly.
- Visually check for blocked port holes, especially near the pilot. Blocked port holes may cause delayed ignition.
- Visually check pilot light and burner when in operation. Flames should be steady, not lifting or floating.

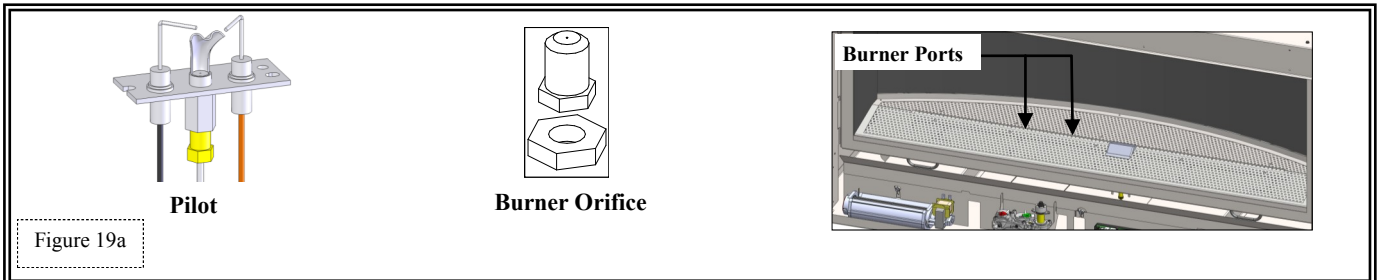

FAN

The fan should be disconnected from electrical current, and cleaned (vacuumed) every six months. The bearings are sealed and require no oiling.

VENT SYSTEM

Annual examination of venting system by a qualified agency is required.

IF VENT-AIR INTAKE SYSTEM IS DISASSEMBLED FOR ANY REASON, RE-INSTALL PER INSTRUCTIONS PROVIDED WITH INITIAL INSTALLATION.

The flow of combustion and ventilation air must not be obstructed.

GLASS CLEANING & REPLACEMENT

- Clean glass only when cool and only with non-abrasive cleansers.
- **CAUTION:** Do not operate the appliance with glass removed, cracked or broken. Replacement of the panel(s) should be done by a licensed or qualified service person.
- Use protective gloves to handle any broken or damaged glass assembly components.
- The glass assembly, part #SL42-057T, shall only be replaced as a complete unit, as supplied by Hussong Mfg. Co., Inc.
- Replacement of glass & frame assembly, part #SL42-057T, must only be performed by a licensed or qualified service person.
DO NOT SUBSTITUTE MATERIALS.
- Do not strike or slam glass door assembly.

IMPORTANT

ANY SAFETY SCREEN OR GUARD REMOVED FOR SERVICING MUST BE REPLACED PRIOR TO OPERATING THE APPLIANCE.

CAUTION

LABEL ALL WIRES PRIOR TO DISCONNECTION WHEN SERVICING CONTROLS. WIRING ERRORS CAN CAUSE IMPROPER AND DANGEROUS OPERATION. VERIFY PROPER OPERATION AFTER SERVICING.

KEEP APPLIANCE AREA CLEAR OF COMBUSTIBLE MATERIALS, SUCH AS GASOLINE AND OTHER FLAMMABLE VAPORS AND LIQUIDS.

REPLACEMENT PARTS LIST

Replacement parts are available through your local dealer. Contact them for availability and pricing.

CONTROL BOARD AND PARTS

SL42-150	Control Board - Nat Gas	700-504	Valve Step Motor - Natural Gas
SL42-151	Control Board - LP Gas	700-504-1	Valve Step Motor - LP Gas
700-567	SIT IPI Valve - Natural	700-213B	18" Flexible Gas Line-Black
700-567-1	SIT IPI Valve - LP	700-226	Flexible Gas Line-Valve to Burner Connection
700-652	Proflame 2 IFC Control Module	700-231	Natural Gas Orifice #31
700-653	IFC Wire Harness Assembly	700-247	LP Gas Orifice #47
700-596	Pilot Assembly - Natural Gas	NCK-SL42-SP	Natural Gas Conversion Kit
700-596-1	Pilot Assembly - LP Gas	LCK-SL42-SP	LP Gas Conversion Kit
700-408	Remote Control	SL42-035	Burner Tube
700-123	.023N Natural Gas Pilot Orifice	SL42-350	Media Tray
700-114	.014LP LP Gas Pilot Orifice		

GLASS & GLASS GASKET

SL42-005	Replacement Valance
900-006	1-1/8" Glass gasket w/ adhesive
SL42-057T	Valance with 17-5/8" (448mm) x 44-5/16" (1141mm) glass

LIGHT KIT

SL42-BLK	Light Kit (bottom)
600-676	35W 130V Halogen Bulb

Hussong Manufacturing Co., Inc.
P.O. Box 577
204 Industrial Park Drive
Lakefield, MN 56150-0577
USA

SLA-42

www.kozyheat.com